

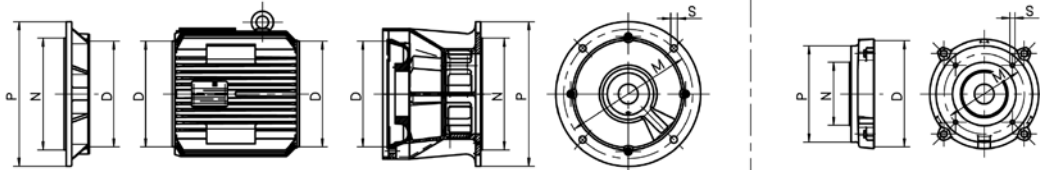

## Flange variants

Type of construction IM 2202

IM B14



		(IE1-)K21R, (IE1-)K22R (IE1-)KPER (IE1-)K11R	63	71	80	90	100	100 LX	112	112	132	132 M4, MX6	160	160	180 M4, L6, 8	180	200 L, LX6	200 LX2	225	250	280	315 S, M	315 MX	315 MY, L, LX	355 M, MY, L	
		(IE1-)K20R (IE1-)KPR	56	63	71	80	90	100	100	112	112	132	132	160	160	180	180	200	200	225	250	280	315 S	315 M	624	
D in mm			88	100	115	131	145	164	164	164	185	216	216	266	266	300	300	335	335	378	428	488	488	530	624	
P	a <sub>1</sub>												350	350	350	350										
N	b <sub>1</sub>												250	250	250	250										
M	e <sub>1</sub>												300	300	300	300										
S	s <sub>1</sub>												18	18	18	18										
P	a <sub>1</sub>															400	400	400	400							
N	b <sub>1</sub>															300	300	300	300							
M	e <sub>1</sub>															350	350	350	350							
S	s <sub>1</sub>															18	18	18	18							
P	a <sub>1</sub>																	450	450							
N	b <sub>1</sub>																	350	350							
M	e <sub>1</sub>																	400	400							
S	s <sub>1</sub>																	18	18							
P	a <sub>1</sub>																			550	550					
N	b <sub>1</sub>																			450	450					
M	e <sub>1</sub>																			500	500					
S	s <sub>1</sub>																			18	18					
P	a <sub>1</sub>																					660	660			
N	b <sub>1</sub>																					550	550			
M	e <sub>1</sub>																					600	600			
S	s <sub>1</sub>																					22	22			

Type of construction IM B14 K, G

		(IE1-)K21R, (IE1-)K22R (IE1-)KPER (IE1-)K11R	63	71	80	90	100	100 LX	112	132...T	132	132 M4, MX6	160	160	180 M4, L6, 8	180	200 L, LX6	200 LX2	225	250	280	315 S, M	315 MX	315 MY, L, LX	355 M, MY, L	
		(IE1-)K20R (IE1-)KPR	56	63	71	80	90	100	100	112	132	132	160	160	180	180	200	200	225	225	250	280	315 S	315 M	624	
D in mm			88	100	115	131	145	164	164	164	185	216	216	266	266	300	300	335	335	378	428	488	488	530	624	
P	a <sub>1</sub>		80	90	105																					
N	b <sub>1</sub>		50	60	70																					
M	e <sub>1</sub>		65	75	85																					
S	s <sub>1</sub>		M5	M5	M6																					
P	a <sub>1</sub>		90	105	120	120	140	140	140	160	160															
N	b <sub>1</sub>		60	70	80	80	95	95	95	110	110															
M	e <sub>1</sub>		75	85	100	100	115	115	115	130	130															
S	s <sub>1</sub>		M5	M6	M6	M6	M8	M8	M8	M8	M8															
P	a <sub>1</sub>		105 <sup>1)</sup>	120	140	140	160	160	160	200	160	200														
N	b <sub>1</sub>		70	80	95	95	110	110	110	130	110	130														
M	e <sub>1</sub>		85	100	115	115	130	130	130	165	130	165														
S	s <sub>1</sub>		M6	M6	M8	M8	M8	M8	M8	M10	M8	M10														
P	a <sub>1</sub>		120	140	160	160	200	200	200	250	200	250	250	300	300											
N	b <sub>1</sub>		80	95	110	110	130	130	130	180	130	180	180	230	230											
M	e <sub>1</sub>		100	115	130	130	165	165	165	215	165	215	215	265	265											
S	s <sub>1</sub>		M6	M8	M8	M8	M10	M10	M10	M12	M10	M12	M12	M12	M12											

<sup>1)</sup> Protruding flange

**Energy-saving motor for Standard Efficiency IE1**  
**Three-phase motors with squirrel-cage rotor**

with surface cooling, type of cooling IC 411, degree of protection IP 55  
 Size 56 to 280

**Type of construction IM B3 [IM 1001]**

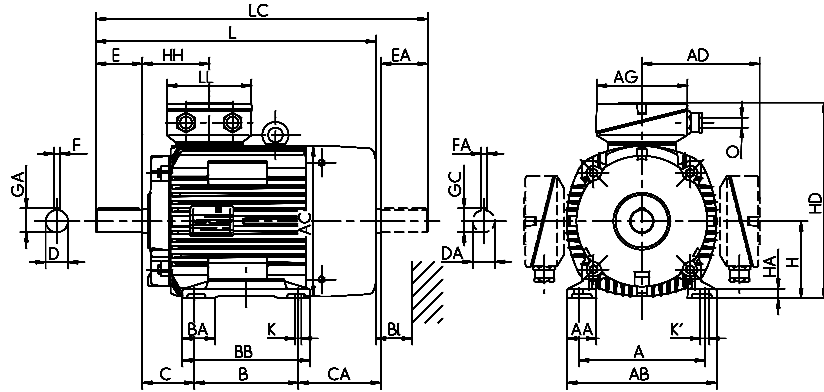

Type designation	Flange size	A	AA	AB	AC	AD	AD	B	BA	BB	C	CA	D	DA	DB <sup>1)</sup>	E	EA	F	FA
		b	n	f	g	g1	g1	a	m	e	w1	w2	d	d1	l	l1	u	u1	
K210 56 K2, 4 U	FF100	90	18	110	-	98		71	-	86	36	28	9	9	M3	20	20	3	3
K21R 56 G2, 4	FF100	90	18	110	109	98		71	-	86	36	52	9	9	M3	20	20	3	3
K21R 63 K2, 4, 6	FF115	100	28	128	109	98		80	-	100	40	39	11	11	M4	23	23	4	4
K21R 63 G2, 4, 6	FF115	100	28	128	109	98		80	-	100	40	39	11	11	M4	23	23	4	4
K21R 71 K2, 4, 6, 8	FF130	112	32	138	124	104		90	-	116	45	43.5	14	14	M5	30	30	5	5
K21R 71 G2, 4, 6, 8	FF130	112	32	138	124	104		90	-	116	45	43.5	14	14	M5	30	30	5	5
IE1-K21R 80 K2, 4, 6, 8	FF 165	125	38	168	139	111		100	-	125	50	63	19	19	M6	40	40	6	6
IE1-K21R 80 G2, 4, 6, 8	FF 165	125	38	168	139	111		100	-	125	50	63	19	19	M6	40	40	6	6
IE1-K21R 90 S2, 4, 6, 8	FF 165	140	40	178	157	119		100	-	130	56	74	24	22	M8	50	50	8	6
IE1-K21R 90 L2, 4, 6, 8	FF 165	140	40	178	157	119	125	-	155	56	71	24	22	M8	50	50	8	6	
IE1-K21R 100 L2, 4, 6, 8	FF 215	160	47	192	177	126		140	-	175	63	73	28	24	M10	60	50	8	8
IE1-K21R 100 LX4, 8	FF 215	160	42	193	196	136		140	-	175	63	102	28	28	M10	60	60	8	8
IE1-K21R 112 M2	FF 215	190	52	225	196	136		140	-	180	70	95	28	28	M10	60	60	8	8
IE1-K21R 112 M6, 8	FF 215	190	52	225	196	136		140	-	180	70	95	28	28	M10	60	60	8	8
IE1-K21R 112 MX2	FF 215	190	52	225	196	136		140	-	180	70	129	28	28	M10	60	60	8	8
IE1-K21R 112 M4	FF 215	190	52	225	196	136		140	-	180	70	129	28	28	M10	60	60	8	8
IE1-K21R 132 S2, 6, 8T	FF265	216	52	257	196	155		140	-	180	89	129	38	28	M12	80	60	10	8
IE1-K21R 132 S4T	FF265	216	52	257	196	155		140	-	180	89	129	38	28	M12	80	60	10	8
IE1-K21R 132 S2	FF265	216	50	256	217	178	189	140	55	180	89	153	38	32	M12	80	80	10	10
IE1-K21R 132 SX2T	FF265	216	52	257	196	155		140	-	180	89	129	38	28	M12	80	60	10	8
IE1-K21R 132 SX2	FF265	216	50	256	217	178	189	140	55	180	89	173	38	32	M12	80	80	10	10
IE1-K21R 132 S4, 6, 8	FF265	216	50	256	217	178	189	140	55	180	89	153	38	32	M12	80	80	10	10
IE1-K21R 132 M4	FF265	216	50	256	258	199	210	178	55	218	89	138	38	38	M12	80	80	10	10
IE1-K21R 132 MX6	FF265	216	50	256	258	199	210	178	55	218	89	138	38	38	M12	80	80	10	10
IE1-K21R 132 M6, 8	FF265	216	50	256	217	178	189	178	55	218	89	135	38	32	M12	80	80	10	10
IE1-K21R 160 M2	FF300	254	55	296	258	214	214	210	60	257	108	135	42	38	M16	110	80	12	10
IE1-K21R 160 M4, 6, 8	FF300	254	55	296	258	214	214	210	60	257	108	135	42	38	M16	110	80	12	10
IE1-K21R 160 MX8	FF300	254	55	296	258	214	214	210	60	257	108	135	42	38	M16	110	80	12	10
IE1-K21R 160 MX2	FF300	254	55	296	313	242	275	210	60	257	108	148	42	42	M16	110	110	12	12
IE1-K21R 160 L2, 4, 6, 8	FF300	254	55	296	313	242	275	254	60	301	108	142	42	42	M16	110	110	12	12
IE1-K21R 180 M2	FF300	279	62	328	351	261	294	241	65	288	121	169	48	48	M16	110	110	14	14
IE1-K21R 180 M4	FF300	279	62	328	313	242	275	241	65	288	121	142	48	42	M16	110	110	14	12
IE1-K21R 180 L4	FF300	279	62	328	351	261	294	279	65	326	121	176	48	48	M16	110	110	14	14
IE1-K21R 180 L6, 8	FF300	279	62	328	313	242	275	279	65	326	121	104	48	42	M16	110	110	14	12
IE1-K21R 200 L2, 4, 6, 8	FF 350	318	70	372	351	261	294	305	70	360	133	138	55	48	M20	110	110	16	14
IE1-K21R 200 LX6	FF 350	318	70	372	351	261	294	305	70	360	133	138	55	48	M20	110	110	16	14
IE1-K21R 200 LX2	FF 350	318	70	372	390	300	378	305	70	360	133	193	55	55	M20	110	110	16	16
IE1-K21R 225 S4, 8	FF 400	356	75	413	390	300	378	286	75	343	149	196	60	55	M20	140	110	18	16
IE1-K21R 225 M2	FF 400	356	75	413	390	300	378	311	75	368	149	211	55	55	M20	110	110	16	16
IE1-K21R 225 M4	FF 400	356	75	413	390	300	378	311	75	368	149	211	60	55	M20	140	110	18	16
IE1-K21R 225 M6, 8	FF 400	356	75	413	390	300	378	311	75	368	149	171	60	55	M20	140	110	18	16
IE1-K21R 250 M2	FF 500	406	84	471	440	358	406	349	84	412	168	210	60	55	M20	140	110	18	16
IE1-K21R 250 M4, 6, 8	FF 500	406	84	471	440	358	406	349	84	412	168	210	65	55	M20	140	110	18	16
IE1-K21R 280 S2	FF 500	457	94	522	490	386	399	368	96	431	190	234	65	65	M20	140	140	18	18
IE1-K21R 280 S4, 6, 8	FF 500	457	94	522	490	386	399	368	96	431	190	234	75	65	M20	140	140	20	18
IE1-K21R 280 M2	FF 500	457	94	522	490	386	399	419	96	482	190	229	65	65	M20	140	140	18	18
IE1-K21R 280 M4, 6, 8	FF 500	457	94	522	490	386	399	419	96	482	190	229	75	65	M20	140	140	20	18

<sup>1)</sup> Centre holes to DIN 332-DS

## Energy-saving motor for Standard Efficiency IE1 Three-phase motors with squirrel-cage rotor

with surface cooling, type of cooling IC 411, degree of protection IP 55  
Size 56 to 280

### Type of construction IM B35 [IM 2001]

Flange dimensions, see page 2/109

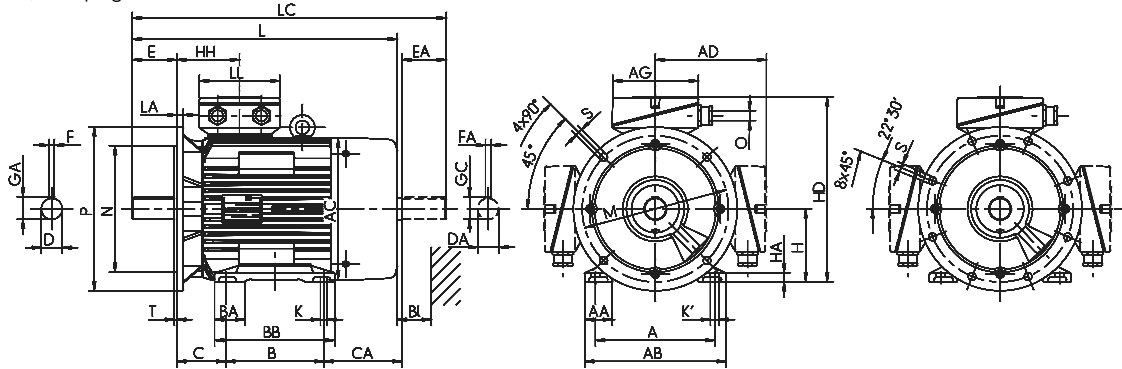

Type designation	GA	GC	H	HA	HD	HD <sup>*)</sup>	HD	HH	K	K'	L	LC	TB Type	AG	LL	TB Type	AG	LL	O	Hole pattern	Bl.
	t	t1	h	c	p	p	p	A	s	s'	k	k1		X	Z	VIK	X	Z			Bl
K210 56 K2, 4 U	10.2	10.2	56	7	154	***)		58	6	6	150	175	KA 05	92	92				M20 x 1.5	4L	14
K21R 56 G2, 4	10.2	10.2	56	7	154	***)		58	6	6	176	199	KA 05	92	92				M20 x 1.5	4L	14
K21R 63 K2, 4, 6	12.5	12.5	63	10	161	***)		58	8	8	179	205	KA 05	92	92				M20 x 1.5	4L	14
K21R 63 G2, 4, 6	12.5	12.5	63	10	161	***)		58	8	8	179	205	KA 05	92	92				M20 x 1.5	4L	14
K21R 71 K2, 4, 6, 8	16	16	71	11	175	***)		61	8	8	206	239	KA 05	92	92				M20 x 1.5	4L	14
K21R 71 G2, 4, 6, 8	16	16	71	11	175	***)		61	8	8	206	239	KA 05	92	92				M20 x 1.5	4L	14
IE1-K21R 80 K2, 4, 6, 8	21.5	21.5	80	12	191	***)		67	10	10	249	293	KA 05	92	92				M20 x 1.5	4L	16
IE1-K21R 80 G2, 4, 6, 8	21.5	21.5	80	12	191	***)		67	10	10	249	293	KA 05	92	92				M20 x 1.5	4L	16
IE1-K21R 90 S2, 4, 6, 8	27	24.5	90	14	210	***)		70	10	10	275	330	KA 05	92	92				M25 x 1.5	4L	16
IE1-K21R 90 L2, 4, 6, 8	27	24.5	90	14	210	***)		70	10	10	297	352	KA 05	92	92				M25 x 1.5	4L	16
IE1-K21R 100 L2, 4, 6, 8	31	27	100	15	227	***)		75	12	12	331	386	KA 05	92	92				M25 x 1.5	4L	18
IE1-K21R 100 LX4, 8	31	31	100	13	237	***)		77	12	12	357	425	KA 05	92	92				M25 x 1.5	4L	20
IE1-K21R 112 M2	31	31	112	18	249	***)		77	12	12	357	425	KA 05	92	92				M25 x 1.5	4L	20
IE1-K21R 112 M6, 8	31	31	112	18	249	***)		77	12	12	357	425	KA 05	92	92				M25 x 1.5	4L	20
IE1-K21R 112 MX2	31	31	112	18	249	***)		77	12	12	391	459	KA 05	92	92				M25 x 1.5	4L	20
IE1-K21R 112 M4	31	31	112	18	249	***)		77	12	12	391	459	KA 05	92	92				M25 x 1.5	4L	20
IE1-K21R 132 S2, 6, 8T	41	31	132	18	287	***)		105	12	12	430	498	KA 05-13	104	112				M25 x 1.5	4L	20
IE1-K21R 132 S4T	41	31	132	18	287	***)		105	12	12	460	528	KA 05-13	104	112				M25 x 1.5	4L	20
IE1-K21R 132 S2	41	35	132	16	310	256.5	310	108	12	12	459	542	25 A	156	145	25 AV	143	134	M25 x 1.5	4L	35
IE1-K21R 132 SX2T	41	31	132	18	287	***)		105	12	12	460	528	KA 05-13	104	112				M25 x 1.5	4L	20
IE1-K21R 132 SX2	41	35	132	16	310	256.5	310	108	12	12	479	562	25 A	156	145	25 AV	143	134	M32 x 1.5	4L	35
IE1-K21R 132 S4, 6, 8	41	35	132	16	310	256.5	310	108	12	12	459	542	25 A	156	145	25 AV	143	134	M32 x 1.5	4L	35
IE1-K21R 132 M4	41	41	132	16	331	279	331	114	12	12	481	565	25 A	156	145	25 AV	143	134	M32 x 1.5	4L	35
IE1-K21R 132 MX6	41	41	132	16	331	279	331	114	12	12	481	565	25 A	156	145	25 AV	143	134	M32 x 1.5	4L	35
IE1-K21R 132 M6, 8	41	35	132	16	310	256.5	310	108	12	12	479	562	25 A	156	145	25 AV	143	134	M32 x 1.5	4L	35
IE1-K21R 160 M2	45	41	160	18	363	307	370	114	15	15	559	643	25 A	156	145	25 AV	143	134	M32 x 1.5	4L	35
IE1-K21R 160 M4, 6, 8	45	41	160	18	363	307	370	114	15	15	559	643	25 A	156	145	25 AV	143	134	M32 x 1.5	4L	35
IE1-K21R 160 MX8	45	41	160	18	363	307	370	114	15	15	559	643	25 A	156	145	25 AV	143	134	M32 x 1.5	4L	35
IE1-K21R 160 MX2	45	45	160	18	409	336	435	138	15	20	571	686	63 A	193	167	100/63 AV	223	214	M40 x 1.5	4L	35
IE1-K21R 160 L2, 4, 6, 8	45	45	160	18	409	336	435	138	15	20	609	724	63 A	193	167	100/63 AV	223	214	M40 x 1.5	4L	35
IE1-K21R 180 M2	51.5	51.5	180	20	441	369	476	147	15	20	635	751	63 A	193	167	100/63 AV	223	214	M40 x 1.5	4L	35
IE1-K21R 180 M4	51.5	45	180	20	422	356	459	138	15	20	609	724	63 A	193	167	100/63 AV	223	214	M40 x 1.5	4L	35
IE1-K21R 180 L4	51.5	51.5	180	20	441	369	476	147	15	20	680	796	63 A	193	167	100/63 AV	223	214	M40 x 1.5	4L	35
IE1-K21R 180 L6, 8	51.5	45	180	20	422	369	459	138	15	20	609	724	63 A	193	167	100/63 AV	223	214	M40 x 1.5	4L	35
IE1-K21R 200 L2, 4, 6, 8	59	51.5	200	22	461	389	498	147	19	25	680	796	63 A	193	167	100/63 AV	223	214	M40 x 1.5	4L	35
IE1-K21R 200 LX6	59	51.5	200	22	461	389	498	147	19	25	680	796	63 A	193	167	100/63 AV	223	214	M40 x 1.5	4L	35
IE1-K21R 200 LX2	59	59	200	22	500	417	579	168	19	25	727	851	100 A	213	207	200 A-SB	335	270	M50 x 1.5	4L	35
IE1-K21R 225 S4, 8	64	59	225	25	527	442	605	168	19	25	757	881	100 A	213	207	200 A-SB	335	270	M50 x 1.5	8L	40
IE1-K21R 225 M2	59	59	225	25	527	442	605	168	19	25	767	891	100 A	213	207	200 A-SB	335	270	M50 x 1.5	8L	40
IE1-K21R 225 M4	64	59	225	25	527	442	605	168	19	25	797	921	100 A	213	207	200 A-SB	335	270	M50 x 1.5	8L	40
IE1-K21R 225 M6, 8	64	59	225	25	527	442	605	168	19	25	757	881	100 A	213	207	200 A-SB	335	270	M50 x 1.5	8L	40
IE1-K21R 250 M2	64	59	250	28	608	484	650	177	24	30	862	977	200 A	282	242	200 A-SB	335	270	M63 x 1.5	8L	45
IE1-K21R 250 M4, 6, 8	69	59	250	28	608	484	650	177	24	30	862	977	200 A	282	242	200 A-SB	335	270	M63 x 1.5	8L	45
IE1-K21R 280 S2	69	69	280	32	666	546	677	206	24	30	924	1072	200 A	282	242	200 A-SB	335	270	M63 x 1.5	8L	50
IE1-K21R 280 S4, 6, 8	79.5	69	280	32	666	546	677	206	24	30	924	1072	200 A	282	242	200 A-SB	335	270	M63 x 1.5	8L	50
IE1-K21R 280 M2	69	69	280	32	666	546	677	206	24	30	970	1118	200 A	282	242	200 A-SB	335	270	M63 x 1.5	8L	50
IE1-K21R 280 M4, 6, 8	79.5	69	280	32	666	546	677	206	24	30	970	1118	200 A	282	242	200 A-SB	335	270	M63 x 1.5	8L	50

\*) Terminal box left/right  
\*\*) upon request



## Energy-saving motor for Standard Efficiency IE1 Three-phase motors with squirrel-cage rotor

with surface cooling, type of cooling IC 411, degree of protection IP 55  
Size 315

### Type of construction IM B35 [IM 2001]

Flange dimensions, see page 2/109

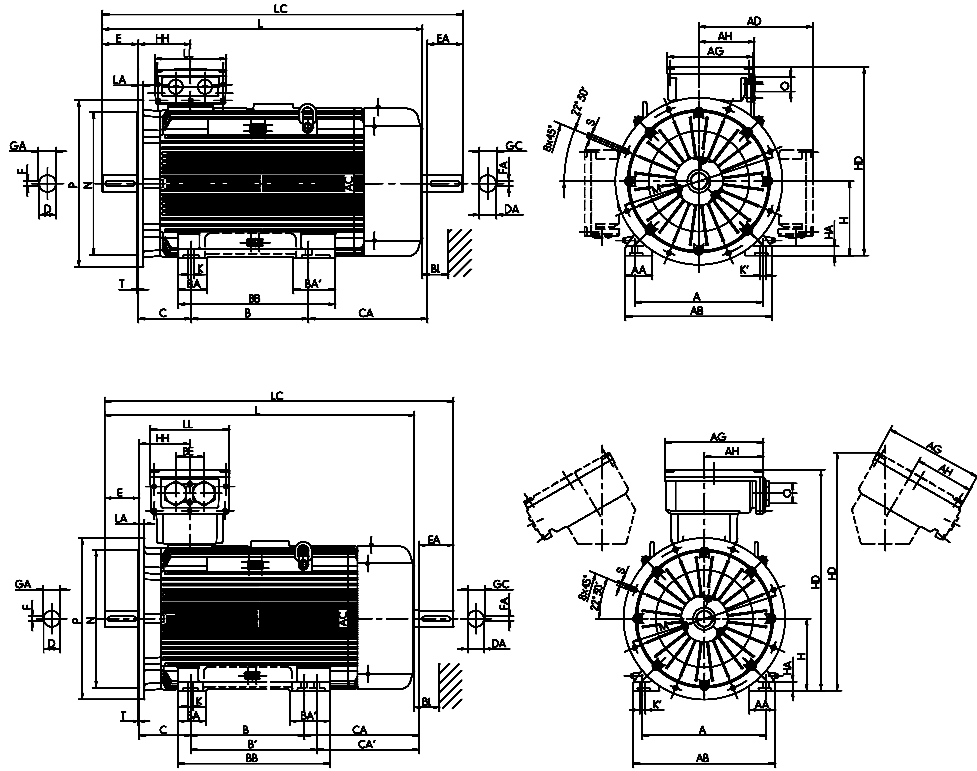

Type designation	GA	GC	H	HA	HD	HD <sup>*)</sup>	HD	HH	K	K'	L	LC	TB Type	AG	LL	AH	TB Type	AG	LL	AH	O	BI
	t	t1	h	c	p	p	p	A	s	s'	k	k1		x	z	-	VIK	x	z	-	r	BI
IE1-K21R 315 S2	69	69	315	44	731	595	775	211	28	35	1050	1218	200 A	282	242	-	400 A-SB	415	340	265	M63 x 1.5	55
IE1-K21R 315 S4, 6, 8	85	74.5	315	44	731	595	775	211	28	35	1080	1248	200 A	282	242	-	400 A-SB	415	340	265	M63 x 1.5	55
IE1-K21R 315 M2	69	69	315	44	731	595	775	211	28	35	1105	1273	200 A	282	242	-	400 A-SB	415	340	265	M63 x 1.5	55
IE1-K21R 315 M4, 6, 8	85	74.5	315	44	731	595	775	211	28	35	1135	1303	200 A	282	242	-	400 A-SB	415	340	265	M63 x 1.5	55
IE1-K21R 315 MX2	69	69	315	44	731	595	775	211	28	35	1185	1353	200 A	282	242	-	400 A-SB	415	340	265	M63 x 1.5	55
IE1-K21R 315 MX4	85	74.5	315	44	731	595	775	211	28	35	1210	1383	200 A	282	242	-	400 A-SB	415	340	265	M63 x 1.5	55
IE1-K21R 315 MX6, 8	85	74.5	315	44	731	595	775	211	28	35	1135	1303	200 A	282	242	-	400 A-SB	415	340	265	M63 x 1.5	55
IE1-K21R 315 MX10, 12	85	74.5	315	44	731	595	775	211	28	35	1135	1303	200 A	282	242	-	400 A-SB	415	340	265	M63 x 1.5	55
IE1-K21R 315 MY2	69	69	315	44	774	628	996	230	28	35	1270	1448	400 A-SB	415	340	265	630 A	496	390	301	M63 x 1.5	55
IE1-K21R 315 MY4, 6, 8	85	74.5	315	44	774	628	996	230	28	35	1300	1478	400 A-SB	415	340	265	630 A	496	390	301	M63 x 1.5	55
IE1-K21R 315 L2	69	69	315	44	774	628	996	230	28	35	1390	1543	400 A-SB	415	340	265	630 A	496	390	301	M63 x 1.5	55
IE1-K21R 315 L4, 6, 8	85	74.5	315	44	774	628	996	230	28	35	1420	1598	400 A-SB	415	340	265	630 A	496	390	301	M63 x 1.5	55
IE1-K21R 315 LX2	69	69	315	44	796	628	996	230	28	35	1510	1688	400 A-SB	415	340	265	630 A	496	390	301	M63 x 1.5	55
IE1-K21R 315 LX4	85	74.5	315	44	796	628	996	230	28	35	1540	1723	400 A-SB	415	340	265	630 A	496	390	301	M63 x 1.5	55
IE1-K21R 315 LX6, 8	85	74.5	315	44	796	628	996	230	28	35	1420	1598	400 A-SB	415	340	265	630 A	496	390	301	M63 x 1.5	55

<sup>\*)</sup> Terminal box left/right

**Energy-saving motor for Standard Efficiency IE1**  
**Three-phase motors with squirrel-cage rotor**

with surface cooling, type of cooling IC 411, degree of protection IP 55  
 Size 355

**Type of construction IM V1 [IM 3011]**

Flange dimensions, see page 2/109

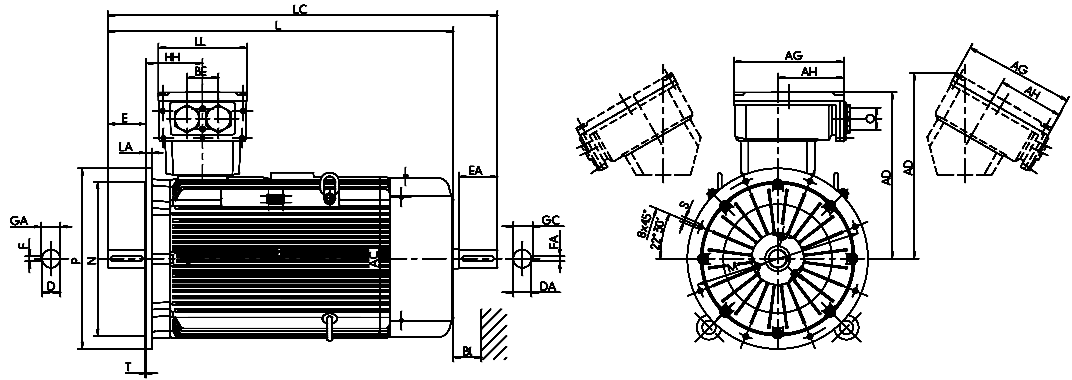

Type designation	Flange size	AC	AD	AD <sup>*)</sup>	D	DA	DB <sup>*)</sup>	E	EA	F	FA
		g	g1	g1	d	d1		l	l1	u	u1
IE1-K22R 355 MY2G, M2 G	FF 740	715	736	817	80	80	M20	170	-	22	-
IE1-K22R 355 MY4, 6, 8	FF 740	715	736	817	100	80	M24	210	170	28	22
IE1-K22R 355 M4	FF 740	715	736	817	100	80	M24	210	170	28	22
IE1-K22R 355 M6, 8	FF 740	715	736	817	100	80	M24	210	170	28	22
IE1-K22R 355 MX6, 8	FF 740	715	736	817	100	80	M24	210	170	28	22
IE1-K22R 355 MX2 G	FF 740	715	728	819	80	80	M20	170	-	22	-
IE1-K22R 355 LY2 G, L2 G	FF 740	715	728	819	80	80	M20	170	-	22	-
IE1-K22R 355 MX4	FF 740	715	728	819	100	80	M24	210	170	28	22
IE1-K22R 355 LY, L4	FF 740	715	728	819	100	80	M24	210	170	28	22
IE1-K22R 355 LY6, 8	FF 740	715	728	819	100	80	M24	210	170	28	22

<sup>\*)</sup> Centre holes to DIN 332-DS  
<sup>\*\*)</sup> Terminal box inclined left/right

Type designation	GA	GC	H	HH	L	LC	TB Type Standard	AG	LL	AH	BE	O	BI.
	t	t1	h	A	K	K1	VIK	x	z	-	-	r	BI
IE1-K22R 355 MY2G, M2 G	85	-	355	250	1530	-	KK 630 A	496	390	301	140	M72 x 2	60
IE1-K22R 355 MY4, 6, 8	106	85	355	250	1570	1755	KK 630 A	496	390	301	140	M72 x 2	60
IE1-K22R 355 M4	106	85	355	250	1570	1755	KK 630 A	496	390	301	140	M72 x 2	60
IE1-K22R 355 M6, 8	106	85	355	250	1570	1755	KK 630 A	496	390	301	140	M72 x 2	60
IE1-K22R 355 MX6, 8	106	85	355	327	1690	1875	KK 630 A	496	390	301	140	M72 x 2	60
IE1-K22R 355 MX2 G	85	-	355	327	1650	-	KK 1000 A	615	474	385	200	M72 x 2	60
IE1-K22R 355 LY2G, L2 G	85	-	355	327	1650	-	KK 1000 A	615	474	385	200	M72 x 2	60
IE1-K22R 355 MX4	106	85	355	327	1690	1875	KK 1000 A	615	474	385	200	M72 x 2	60
IE1-K22R 355 LY, L4	106	85	355	327	1690	1875	KK 1000 A	615	474	385	200	M72 x 2	60
IE1-K22R 355 LY6, 8	106	85	355	327	1690	1875	KK 1000 A	615	474	385	200	M72x2	60



**Energy-saving motor for Standard Efficiency IE1**  
**Three-phase motors with squirrel-cage rotor**

with surface cooling, type of cooling IC 411, degree of protection IP 55  
 Size 56 to 180

**Type of construction IM B34 [IM 2101]**

Flange dimensions, see page 2/109

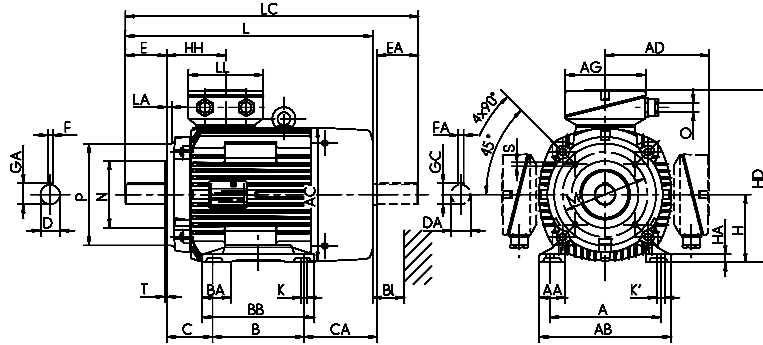

Type designation	Flange size		A	AA	AB	AC	AD	AD	B	BA	BB	C	CA	D	DA	DB <sup>1)</sup>	E	EA	F	FA
	small	large	b	n	f	g	g1	g1	a	m	e	w1	w2	d	d1		l	l1	u	u1
	VIK																			
K210 56 K2, 4 U	FT 65	FT 85	90	18	110	-	98		71	-	86	36	28	9	9	M3	20	20	3	3
K21R 56 G2, 4	FT 65	FT 85	90	18	110	109	98		71	-	86	36	52	9	9	M3	20	20	3	3
K21R 63 K2, 4, 6	FT 75	FT 100	100	28	128	109	98		80	-	100	40	39	11	11	M4	23	23	4	4
K21R 63 G2, 4, 6	FT 75	FT 100	100	28	128	109	98		80	-	100	40	39	11	11	M4	23	23	4	4
K21R 71 K2, 4, 6, 8	FT 85	FT 115	112	32	138	124	104		90	-	116	45	43.5	14	14	M5	30	30	5	5
K21R 71 G2, 4, 6, 8	FT 85	FT 115	112	32	138	124	104		90	-	116	45	43.5	14	14	M5	30	30	5	5
IE1-K21R 80 K2, 4, 6, 8	FT 100	FT 130	125	38	168	139	111		100	-	125	50	63	19	19	M6	40	40	6	6
IE1-K21R 80 G2, 4, 6, 8	FT 100	FT 130	125	38	168	139	111		100	-	125	50	63	19	19	M6	40	40	6	6
IE1-K21R 90 S2, 4, 6, 8	FT 115	FT 130	140	40	178	157	119		100	-	130	56	74	24	22	M8	50	50	8	6
IE1-K21R 90 L2, 4, 6, 8	FT 115	FT 130	140	40	178	157	119		125	-	155	56	71	24	22	M8	50	50	8	6
IE1-K21R 100 L2, 4, 6, 8	FT 130	FT 165	160	47	192	177	126		140	-	175	63	73	28	24	M10	60	50	8	8
IE1-K21R 100 LX4, 8	FT 130	FT 165	160	42	193	196	136		140	-	175	63	102	28	28	M10	60	60	8	8
IE1-K21R 112 M2	FT 130	FT 165	190	50	224	196	136		140	-	180	70	95	28	28	M10	60	60	8	8
IE1-K21R 112 M6, 8	FT 130	FT 165	190	50	224	196	136		140	-	180	70	95	28	28	M10	60	60	8	8
IE1-K21R 112 MX2	FT 130	FT 165	190	50	224	196	136		140	-	180	70	129	28	28	M10	60	60	8	8
IE1-K21R 112 M4	FT 130	FT 165	190	50	224	196	136		140	-	180	70	129	28	28	M10	60	60	8	8
IE1-K21R 132 S2, 6, 8T	FT 130	FT 165	216	52	257	196	155		140	-	180	89	129	38	28	M12	80	60	10	8
IE1-K21R 132 S4T	FT 130	FT 165	216	52	257	196	155		140	-	180	89	129	38	28	M12	80	60	10	8
IE1-K21R 132 S2	FT 130	FT 165	216	50	256	217	178	189	140	55	180	89	153	38	32	M12	80	80	10	10
IE1-K21R 132 SX2T	FT 130	FT 165	216	52	257	196	155		140	-	180	89	129	38	28	M12	80	60	10	8
IE1-K21R 132 SX2	FT 130	FT 165	216	50	256	217	178	189	140	55	180	89	173	38	32	M12	80	80	10	10
IE1-K21R 132 S4, 6, 8	FT 130	FT 165	216	50	256	217	178	189	140	55	180	89	153	38	32	M12	80	80	10	10
IE1-K21R 132 M4	FT 165	FT 215	216	50	256	258	199	210	178	55	218	89	138	38	38	M12	80	80	10	10
IE1-K21R 132 MX6	FT 165	FT 215	216	50	256	258	199	210	178	55	218	89	138	38	38	M12	80	80	10	10
IE1-K21R 132 M6, 8	FT 130	FT 165	216	50	256	217	178	189	178	55	218	89	135	38	32	M12	80	80	10	10
IE1-K21R 160 M2	FT 165	FT 215	254	55	296	258	214	214	210	60	257	108	135	42	38	M16	110	80	12	10
IE1-K21R 160 M4, 6, 8	FT 165	FT 215	254	55	296	258	214	214	210	60	257	108	135	42	38	M16	110	80	12	10
IE1-K21R 160 MX8	FT 165	FT 215	254	55	296	258	199	214	210	60	257	108	135	42	38	M16	110	80	12	10
IE1-K21R 160 MX2	FT 215	FT 265	254	55	296	313	242	275	210	60	257	108	148	42	42	M16	110	110	12	12
IE1-K21R 160 L2, 4, 6, 8	FT 215	FT 265	254	55	296	313	242	275	254	60	301	108	142	42	42	M16	110	110	12	12
IE1-K21R 180 M4	FT 265	-	279	62	328	313	242	275	241	65	288	121	142	48	42	M16	110	110	14	12
IE1-K21R 180 L6, 8	FT 265	-	279	62	328	313	242	275	279	65	326	121	104	48	42	M16	110	110	14	12

<sup>1)</sup> Centre holes to DIN 332-DS

## Energy-saving motor for Standard Efficiency IE1 Three-phase motors with squirrel-cage rotor

with surface cooling, type of cooling IC 411, degree of protection IP 55  
Size 56 to 180

### Type of construction IM B14 [IM 3601]

Flange dimensions, see page 2/109

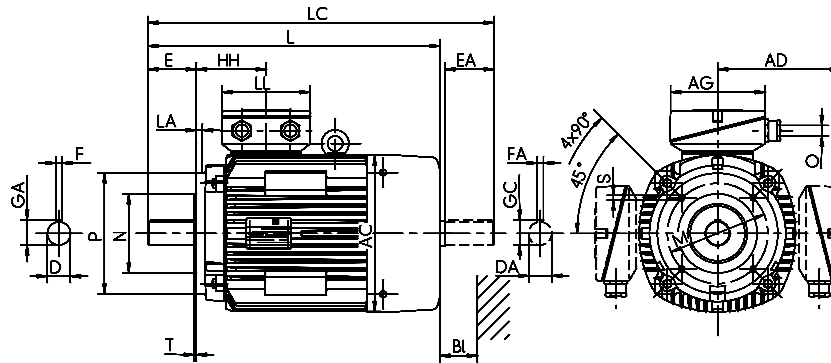

Type designation	GA	GC	H	HA	HD	HD''	HD	HH	K	K'	L	LC	TB Type	AG	LL	TB Type	AG	LL	O	Hole	Bl.
	t	t1	h	c	p	p	p	A	s	s'	k	k1	-	x	z	VIK	x	z	r	pattern	Bl.
K210 56 K2, 4 U	10.2	10.2	56	7	154	***	58	6	6	150	175	KA 05	92	92					M20 x 1.5	4L	-
K21R 56 G2, 4	10.2	10.2	56	7	154	***	58	6	6	176	199	KA 05	92	92					M20 x 1.5	4L	14
K21R 63 K2, 4, 6	12.5	12.5	63	10	161	***	58	8	8	179	205	KA 05	92	92					M20 x 1.5	4L	14
K21R 63 G2, 4, 6	12.5	12.5	63	10	161	***	58	8	8	179	205	KA 05	92	92					M20 x 1.5	4L	14
K21R 71 K2, 4, 6, 8	16	16	71	11	175	***	61	8	8	206	239	KA 05	92	92					M20 x 1.5	4L	14
K21R 71 G2, 4, 6, 8	16	16	71	11	175	***	61	8	8	206	239	KA 05	92	92					M20 x 1.5	4L	14
IE1-K21R 80 K2, 4, 6, 8	21.5	21.5	80	12	191	***	67	10	10	249	293	KA 05	92	92					M20 x 1.5	4L	16
IE1-K21R 80 G2, 4, 6, 8	21.5	21.5	80	12	191	***	67	10	10	249	293	KA 05	92	92					M20 x 1.5	4L	16
IE1-K21R 90 S2, 4, 6, 8	27	24.5	90	14	210	***	70	10	10	275	330	KA 05	92	92					M25 x 1.5	4L	16
IE1-K21R 90 L2, 4, 6, 8	27	24.5	90	14	210	***	70	10	10	297	352	KA 05	92	92					M25 x 1.5	4L	16
IE1-K21R 100 L2, 4, 6, 8	31	27	100	15	227	***	75	12	12	331	386	KA 05	92	92					M25 x 1.5	4L	18
IE1-K21R 100 LX4, 8	31	31	100	13	237	***	77	12	12	357	425	KA 05	92	92					M25 x 1.5	4L	20
IE1-K21R 112 M2	31	31	112	18	249	***	77	12	12	357	425	KA 05	92	92					M25 x 1.5	4L	20
IE1-K21R 112 M6, 8	31	31	112	18	249	***	77	12	12	357	425	KA 05	92	92					M25 x 1.5	4L	20
IE1-K21R 112 MX2	31	31	112	18	249	***	77	12	12	391	459	KA 05	92	92					M25 x 1.5	4L	20
IE1-K21R 112 M4	31	31	112	18	249	***	77	12	12	391	459	KA 05	92	92					M25 x 1.5	4L	20
IE1-K21R 132 S2, 6, 8T	41	31	132	18	287	***	105	12	12	430	498	KA 05-13	104	112					M32 x 1.5	4L	20
IE1-K21R 132 S4T	41	31	132	18	287	***	105	12	12	460	528	KA 05-13	104	112					M32 x 1.5	4L	20
IE1-K21R 132 S2	41	35	132	16	328	275	310	108	12	12	459	542	25 A	156	145	25 AV	143	134	M32 x 1.5	4L	35
IE1-K21R 132 SX2T	41	31	132	18	287	***	105	12	12	460	528	KA 05-13	104	112					M32 x 1.5	4L	20
IE1-K21R 132 SX2	41	35	132	16	328	275	310	108	12	12	479	562	25 A	156	145	25 AV	143	134	M32 x 1.5	4L	35
IE1-K21R 132 S4, 6, 8	41	35	132	16	328	275	310	108	12	12	459	542	25 A	156	145	25 AV	143	134	M32 x 1.5	4L	35
IE1-K21R 132 M4	41	41	132	16	349	297	331	114	12	12	481	565	25 A	156	145	25 AV	143	134	M32 x 1.5	4L	35
IE1-K21R 132 MX6	41	41	132	16	349	297	331	114	12	12	481	565	25 A	156	145	25 AV	143	134	M32 x 1.5	4L	35
IE1-K21R 132 M6, 8	41	35	132	16	328	275	310	108	12	12	479	562	25 A	156	145	25 AV	143	134	M32 x 1.5	4L	35
IE1-K21R 160 M2	45	41	160	18	389	322	370	114	15	15	559	643	63 A	193	167	25 AV	143	134	M32 x 1.5	4L	35
IE1-K21R 160 M4, 6, 8	45	41	160	18	389	322	370	114	15	15	559	643	63 A	193	167	25 AV	143	134	M32 x 1.5	4L	35
IE1-K21R 160 MX8	45	41	160	18	389	322	370	114	15	15	559	643	63 A	193	167	25 AV	143	134	M32 x 1.5	4L	35
IE1-K21R 160 MX2	45	45	160	18	417	351	435	138	15	20	571	686	63 A	193	167	100/63 AV	223	214	M40 x 1.5	4L	35
IE1-K21R 160 L2, 4, 6, 8	45	45	160	18	417	351	435	138	15	20	609	724	63 A	193	167	100/63 AV	223	214	M40 x 1.5	4L	35
IE1-K21R 180 M4	51.5	45	180	20	417	351	459	138	15	20	609	724	63 A	193	167	100/63 AV	223	214	M40 x 1.5	4L	35
IE1-K21R 180 L6, 8	51.5	45	180	20	417	364	459	138	15	20	609	724	63 A	193	167	100/63 AV	223	214	M40 x 1.5	4L	35

\*\*) Terminal box left/right  
\*\*\*) upon request

**Energy-saving motor for Standard Efficiency IE1**  
**Three-phase motors with squirrel-cage rotor**

with surface cooling, type of cooling IC 411, degree of protection IP 55  
 Size 56 to 280

**Type of construction IM B5 [IM 3001]**

**Type of construction IM V1 [IM 3011]**

Flange dimensions, see page 2/109

Type designation	Flange size	AC	AD	AD	D	DA	DB <sup>1)</sup>	E	EA	F	FA	GA	GC
	g	g	g1	VIK g1	d	d1		l	l1	u	u1	t	t1
K210 56 K2, 4 U	FF100	-	98		9	9	M3	20	20	3	3	10.2	10.2
K21R 56 G2, 4	FF100	109	98		9	9	M3	20	20	3	3	10.2	10.2
K21R 63 K2, 4, 6	FF115	109	98		11	11	M4	23	23	4	4	12.5	12.5
K21R 63 G2, 4, 6	FF115	109	98		11	11	M4	23	23	4	4	12.5	12.5
K21R 71 K2, 4, 6, 8	FF130	124	104		14	14	M5	30	30	5	5	16	16
K21R 71 G2, 4, 6, 8	FF130	124	104		14	14	M5	30	30	5	5	16	16
IE1-K21R 80 K2, 4, 6, 8	FF 165	139	111		19	19	M6	40	40	6	6	21.5	21.5
IE1-K21R 80 G2, 4, 6, 8	FF 165	139	111		19	19	M6	40	40	6	6	21.5	21.5
IE1-K21R 90 S2, 4, 6, 8	FF 165	157	119		24	22	M8	50	50	8	6	27	24.5
IE1-K21R 90 L2, 4, 6, 8	FF 165	157	119		24	22	M8	50	50	8	6	27	24.5
IE1-K21R 100 L2, 4, 6, 8	FF 215	177	126		28	24	M10	60	50	8	8	31	27
IE1-K21R 100 LX4, 8	FF 215	196	136		28	28	M10	60	60	8	8	31	31
IE1-K21R 112 M2	FF 215	196	136		28	28	M10	60	60	8	8	31	31
IE1-K21R 112 M6, 8	FF 215	196	136		28	28	M10	60	60	8	8	31	31
IE1-K21R 112 MX2	FF 215	196	136		28	28	M10	60	60	8	8	31	31
IE1-K21R 112 M4	FF 215	196	136		28	28	M10	60	60	8	8	31	31
IE1-K21R 132 S2, 6, 8T	FF265	196	155		38	28	M12	80	60	10	8	41	31
IE1-K21R 132 S4T	FF265	196	155		38	28	M12	80	60	10	8	41	31
IE1-K21R 132 S2	FF265	217	178	189	38	32	M12	80	80	10	10	41	35
IE1-K21R 132 SX2T	FF265	196	155		38	28	M12	80	60	10	8	41	31
IE1-K21R 132 SX2	FF265	217	178	189	38	32	M12	80	80	10	10	41	35
IE1-K21R 132 S4, 6, 8	FF265	217	178	189	38	32	M12	80	80	10	10	41	35
IE1-K21R 132 M4	FF265	258	199	210	38	38	M12	80	80	10	10	41	41
IE1-K21R 132 MX6	FF265	258	199	210	38	38	M12	80	80	10	10	41	41
IE1-K21R 132 M6, 8	FF265	217	178	189	38	32	M12	80	80	10	10	41	35
IE1-K21R 160 M2	FF300	258	214	214	42	38	M16	110	80	12	10	45	41
IE1-K21R 160 M4, 6, 8	FF300	258	214	214	42	38	M16	110	80	12	10	45	41
IE1-K21R 160 MX8	FF300	258	199	214	42	38	M16	110	80	12	10	45	41
IE1-K21R 160 MX2	FF300	313	242	275	42	42	M16	110	110	12	12	45	45
IE1-K21R 160 L2, 4, 6, 8	FF300	313	242	275	42	42	M16	110	110	12	12	45	45
IE1-K21R 180 M2	FF300	351	261	294	48	48	M16	110	110	14	14	51.5	51.5
IE1-K21R 180 M4	FF300	313	242	275	48	42	M16	110	110	14	12	51.5	45
IE1-K21R 180 L4	FF300	351	261	294	48	48	M16	110	110	14	14	51.5	51.5
IE1-K21R 180 L6, 8	FF300	313	242	275	48	42	M16	110	110	14	12	51.5	45
IE1-K21R 200 L2, 4, 6, 8	FF 350	351	261	294	55	48	M20	110	110	16	14	59	51.5
IE1-K21R 200 LX6	FF 350	351	261	294	55	48	M20	110	110	16	14	59	51.5
IE1-K21R 200 LX2	FF 350	390	300	378	55	55	M20	110	110	16	16	59	59
IE1-K21R 225 S4, 8	FF 400	390	300	378	60	55	M20	140	110	18	16	64	59
IE1-K21R 225 M2	FF 400	390	300	378	55	55	M20	110	110	16	16	59	59
IE1-K21R 225 M4	FF 400	390	300	378	60	55	M20	140	110	18	16	64	59
IE1-K21R 225 M6, 8	FF 400	390	300	378	60	55	M20	140	110	18	16	64	59
IE1-K21R 250 M2	FF 500	440	358	406	60	55	M20	140	110	18	16	64	59
IE1-K21R 250 M4, 6, 8	FF 500	440	358	406	65	55	M20	140	110	18	16	69	59
IE1-K21R 280 S2	FF 500	490	386	399	65	65	M20	140	140	18	18	69	69
IE1-K21R 280 S4, 6, 8	FF 500	490	386	399	75	65	M20	140	140	20	18	79.5	69
IE1-K21R 280 M2	FF 500	490	386	399	65	65	M20	140	140	18	18	69	69
IE1-K21R 280 M4, 6, 8	FF 500	490	386	399	75	65	M20	140	140	20	18	79.5	69

<sup>1)</sup> Centre holes to DIN 332-DS

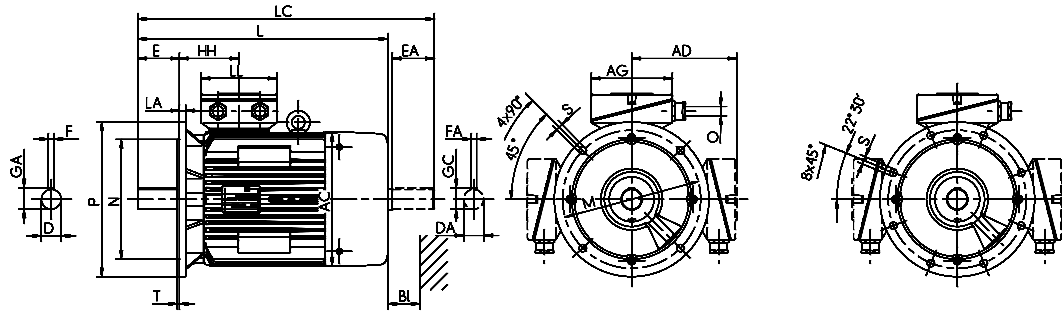

Type designation	H	HH	L	LC	TB Type	AG	LL	TB Type	AG	LL	O	Hole pattern	Bl.
	h	A	k	k1				VIK					Bl
K210 56 K2, 4 U	56	81	173	197	KA 05	92	92				M20 x 1.5	4L	14
K21R 56 G2, 4	56	81	199	223	KA 05	92	92				M20 x 1.5	4L	14
K21R 63 K2, 4, 6	63	58	179	205	KA 05	92	92				M20 x 1.5	4L	14
K21R 63 G2, 4, 6	63	58	179	205	KA 05	92	92				M20 x 1.5	4L	14
K21R 71 K2, 4, 6, 8	71	61	206	239	KA 05	92	92				M20 x 1.5	4L	14
K21R 71 G2, 4, 6, 8	71	61	206	239	KA 05	92	92				M20 x 1.5	4L	14
IE1-K21R 80 K2, 4, 6, 8	80	67	249	293	KA 05	92	92				M20 x 1.5	4L	16
IE1-K21R 80 G2, 4, 6, 8	80	67	249	293	KA 05	92	92				M20 x 1.5	4L	16
IE1-K21R 90 S2, 4, 6, 8	90	70	275	330	KA 05	92	92				M25 x 1.5	4L	16
IE1-K21R 90 L2, 4, 6, 8	90	70	297	352	KA 05	92	92				M25 x 1.5	4L	16
IE1-K21R 100 L2, 4, 6, 8	100	75	331	386	KA 05	92	92				M25 x 1.5	4L	18
IE1-K21R 100 LX4, 8	100	77	357	425	KA 05	92	92				M25 x 1.5	4L	20
IE1-K21R 112 M2	112	77	357	425	KA 05	92	92				M25 x 1.5	4L	20
IE1-K21R 112 M6, 8	112	77	391	425	KA 05	92	92				M25 x 1.5	4L	20
IE1-K21R 112 MX2	112	77	391	459	KA 05	92	92				M25 x 1.5	4L	20
IE1-K21R 112 M4	112	77	391	459	KA 05	92	92				M25 x 1.5	4L	20
IE1-K21R 132 S2, 6, 8T	132	105	430	498	KA 05-13	104	112				M32 x 1.5	4L	20
IE1-K21R 132 S4T	132	105	460	528	KA 05-13	104	112				M32 x 1.5	4L	20
IE1-K21R 132 S2	132	108	459	542	25 A	156	145	25 AV	143	134	M32 x 1.5	4L	35
IE1-K21R 132 SX2T	132	105	460	528	KA 05-13	104	112				M32 x 1.5	4L	20
IE1-K21R 132 SX2	132	108	479	562	25 A	156	145	25 AV	143	134	M32 x 1.5	4L	35
IE1-K21R 132 S4, 6, 8	132	108	459	542	25 A	156	145	25 AV	143	134	M32 x 1.5	4L	35
IE1-K21R 132 M4	132	114	481	565	25 A	156	145	25 AV	143	134	M32 x 1.5	4L	35
IE1-K21R 132 MX6	132	114	481	565	25 A	156	145	25 AV	143	134	M32 x 1.5	4L	35
IE1-K21R 132 M6, 8	132	108	479	562	25 A	156	145	25 AV	143	134	M32 x 1.5	4L	35
IE1-K21R 160 M2	160	114	559	643	25 A	156	145	25 AV	143	134	M32 x 1.5	4L	35
IE1-K21R 160 M4, 6, 8	160	114	559	643	25 A	156	145	25 AV	143	134	M32 x 1.5	4L	35
IE1-K21R 160 MX8	160	114	559	643	25 A	156	145	25 AV	143	134	M32 x 1.5	4L	35
IE1-K21R 160 MX2	160	138	571	686	63 A	193	167	100/63 AV	223	214	M40 x 1.5	4L	35
IE1-K21R 160 L2, 4, 6, 8	160	138	609	724	63 A	193	167	100/63 AV	223	214	M40 x 1.5	4L	35
IE1-K21R 180 M2	180	147	635	751	63 A	193	167	100/63 AV	223	214	M40 x 1.5	4L	35
IE1-K21R 180 M4	180	138	609	724	63 A	193	167	100/63 AV	223	214	M40 x 1.5	4L	35
IE1-K21R 180 L4	180	147	680	796	63 A	193	167	100/63 AV	223	214	M40 x 1.5	4L	35
IE1-K21R 180 L6, 8	180	138	609	724	63 A	193	167	100/63 AV	223	214	M40 x 1.5	4L	35
IE1-K21R 200 L2, 4, 6, 8	200	147	680	796	63 A	193	167	100/63 AV	223	214	M40 x 1.5	4L	35
IE1-K21R 200 LX6	200	147	680	796	63 A	193	167	100/63 AV	223	214	M40 x 1.5	4L	35
IE1-K21R 200 LX2	200	168	727	851	100 A	213	207	200 A-SB	335	270	M50 x 1.5	4L	35
IE1-K21R 225 S4, 8	225	168	757	881	100 A	213	207	200 A-SB	335	270	M50 x 1.5	8L	40
IE1-K21R 225 M2	225	168	767	891	100 A	213	207	200 A-SB	335	270	M50 x 1.5	8L	40
IE1-K21R 225 M4	225	168	797	921	100 A	213	207	200 A-SB	335	270	M50 x 1.5	8L	40
IE1-K21R 225 M6, 8	225	168	757	881	100 A	213	207	200 A-SB	335	270	M50 x 1.5	8L	40
IE1-K21R 250 M2	250	177	862	977	200 A	282	242	200 A-SB	335	270	M63 x 1.5	8L	45
IE1-K21R 250 M4, 6, 8	250	177	862	977	200 A	282	242	200 A-SB	335	270	M63 x 1.5	8L	45
IE1-K21R 280 S2	280	206	924	1072	200 A	282	242	200 A-SB	335	270	M63 x 1.5	8L	50
IE1-K21R 280 S4, 6, 8	280	206	924	1072	200 A	282	242	200 A-SB	335	270	M63 x 1.5	8L	50
IE1-K21R 280 M2	280	206	970	1118	200 A	282	242	200 A-SB	335	270	M63 x 1.5	8L	50
IE1-K21R 280 M4, 6, 8	280	206	970	1118	200 A	282	242	200 A-SB	335	270	M63 x 1.5	8L	50

**Energy-saving motor for Standard Efficiency IE1**  
**Three-phase motors with squirrel-cage rotor**

with surface cooling, type of cooling IC 411, degree of protection IP 55  
 Size 315

**Type of construction IM B5 [IM 3001] to Size 315 MY**

**Type of construction IM V1 [IM 3011]**

Flange dimensions, see page 2/109

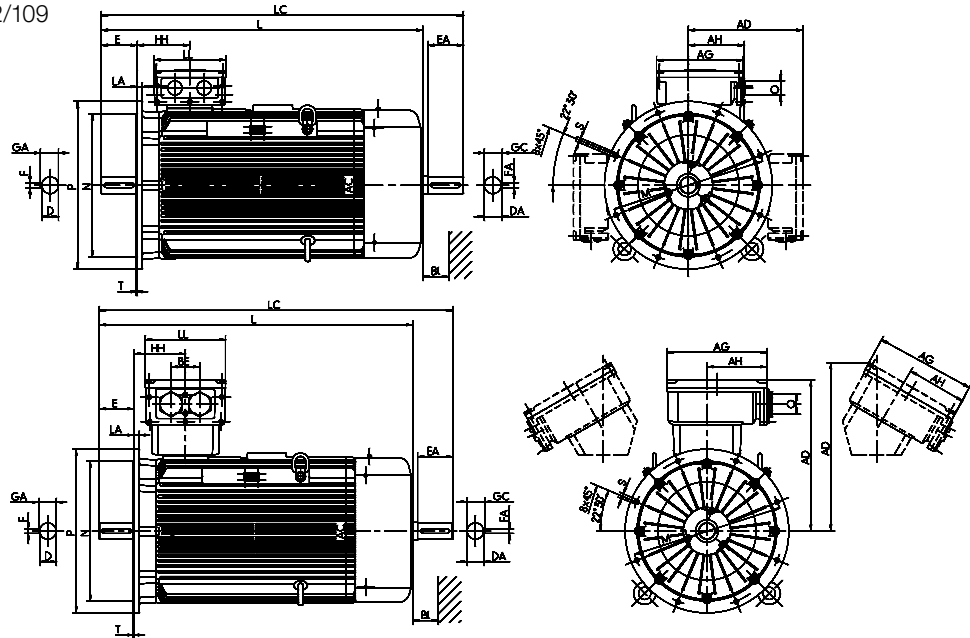

Type designation	Flange size	AC	AD	AD	D	DA	DB <sup>1)</sup>	E	EA	F	FA	GA	GC
	g	g1	g1	VK	d	d1		l	l1	u	u1	t	t1
IE1-K21R 315 S2	FF 600	550	416	460	65	65	M20	140	140	18	18	69	69
IE1-K21R 315 S4, 6, 8	FF 600	550	416	460	80	70	M20	170	140	22	20	85	74.5
IE1-K21R 315 M2	FF 600	550	416	460	65	65	M20	140	140	18	18	69	69
IE1-K21R 315 M4, 6, 8	FF 600	550	416	460	80	70	M20	170	140	22	20	85	74.5
IE1-K21R 315 MX2	FF 600	550	416	460	65	65	M20	140	140	18	18	69	69
IE1-K21R 315 MX4	FF 600	550	416	460	80	70	M20	170	140	22	20	85	74.5
IE1-K21R 315 MX6, 8	FF 600	550	416	460	80	70	M20	170	140	22	20	85	74.5
IE1-K21R 315 MX10, 12	FF 600	550	416	460	80	70	M20	170	140	22	20	85	74.5
IE1-K21R 315 MY2	FF 600	610	498	681	65	65	M20	140	140	18	18	69	69
IE1-K21R 315 MY4, 6, 8	FF 600	610	498	681	80	70	M20	170	140	22	20	85	74.5
IE1-K21R 315 L2	FF 600	610	498	681	65	65	M20	140	140	18	18	69	69
IE1-K21R 315 L4, 6, 8	FF 600	610	498	681	80	70	M20	170	140	22	20	85	74.5
IE1-K21R 315 LX2	FF 600	610	481	681	65	65	M20	140	140	18	18	69	69
IE1-K21R 315 LX4	FF 600	610	481	681	80	70	M20	170	140	22	20	85	74.5
IE1-K21R 315 LX6, 8	FF 600	610	498	681	80	70	M20	170	140	22	20	85	74.5

Type designation	H	HH	L	LC	TB Type	AG	LL	AH	TB Type	AG	LL	AH	O	BI
	h	A	k	k1	x	z	-	VIK	x	z	-	r	BI	
IE1-K21R 315 S2	315	211	1050	1218	200 A	282	242	-	400 A-SB	415	340	265	M63 x 1.5	55
IE1-K21R 315 S4, 6, 8	315	211	1080	1248	200 A	282	242	-	400 A-SB	415	340	265	M63 x 1.5	55
IE1-K21R 315 M2	315	211	1105	1273	200 A	282	242	-	400 A-SB	415	340	265	M63 x 1.5	55
IE1-K21R 315 M4, 6, 8	315	211	1135	1303	200 A	282	242	-	400 A-SB	415	340	265	M63 x 1.5	55
IE1-K21R 315 MX2	315	211	1185	1353	200 A	282	242	-	400 A-SB	415	340	265	M63 x 1.5	55
IE1-K21R 315 MX4	315	211	1215	1383	200 A	282	242	-	400 A-SB	415	340	265	M63 x 1.5	55
IE1-K21R 315 MX6, 8	315	211	1135	1303	200 A	282	242	-	400 A-SB	415	340	265	M63 x 1.5	55
IE1-K21R 315 MX10, 12	315	211	1135	1303	200 A	282	242	-	400 A-SB	415	340	265	M63 x 1.5	55
IE1-K21R 315 MY2	315	230	1270	1448	400 A-SB	415	340	265	630 A	496	390	301	M63 x 1.5	55
IE1-K21R 315 MY4, 6, 8	315	230	1300	1478	400 A-SB	415	340	265	630 A	496	390	301	M63 x 1.5	55
IE1-K21R 315 L2	315	230	1390	1543	400 A-SB	415	340	265	630 A	496	390	301	M63 x 1.5	55
IE1-K21R 315 L4, 6, 8	315	230	1420	1598	400 A-SB	415	340	265	630 A	496	390	301	M63 x 1.5	55
IE1-K21R 315 LX2	315	230	1510	1688	400 A-SB	415	340	265	630 A	496	390	301	M63 x 1.5	55
IE1-K21R 315 LX4	315	230	1540	1723	400 A-SB	415	340	265	630 A	496	390	301	M63 x 1.5	55
IE1-K21R 315 LX6, 8	315	230	1420	1598	400 A-SB	415	340	265	630 A	496	390	301	M63 x 1.5	55

<sup>1)</sup> Centre holes to DIN 332-DS

## Energy-saving motor for Standard Efficiency IE1 Three-phase motors with squirrel-cage rotor

with surface cooling, type of cooling IC 411, degree of protection IP 55  
Size 355

### Type of construction IM B3 [IM 1001]

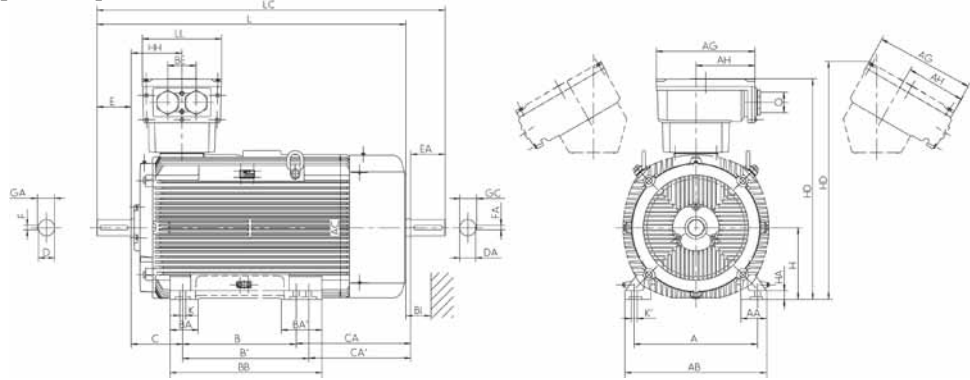

### Type of construction IM B35 [IM 2001]

Flange dimensions, see page 2/109

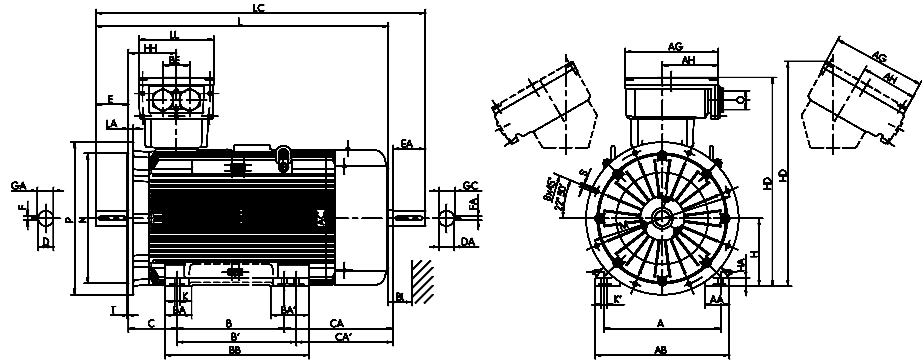

Type designation	Flange size	A	AA	AB	AC	B	BA	BA'	BB	C	CA	D	DA	DB <sup>1)</sup>	E	EA	F	FA
	b	n	f	g	a	m	m1	e	w1	w2	d	d1		l	l1	u	u1	
IE1-K22R 355 MY2G, M2G	FF 740	610	130	700	715	560	140	200	750	254	561	80	80	M20	170	-	22	-
IE1-K22R 355 MY4, 6, 8	FF 740	610	130	700	715	560	140	200	750	254	561	100	80	M24	210	170	28	22
IE1-K22R 355 M4	FF 740	610	130	700	715	560	140	200	750	254	561	100	80	M24	210	170	28	22
IE1-K22R 355 M6, 8	FF 740	610	130	700	715	560	140	200	750	254	561	100	80	M24	210	170	28	22
IE1-K22R 355 MX6, 8	FF 740	610	130	700	715	560	140	200	750	254	681	100	80	M24	210	170	28	22
IE1-K22R 355 MX2G	FF 740	610	130	700	715	560	140	200	750	254	681	80	80	M20	170	-	22	-
IE1-K22R 355 LY2G, L2G	FF 740	610	130	700	715	630	140	200	750	254	611	80	80	M20	170	-	22	-
IE1-K22R 355 MX4	FF 740	610	130	700	715	560	140	200	750	254	681	100	80	M24	210	170	28	22
IE1-K22R 355 LY4, L4	FF 740	610	130	700	715	630	140	200	750	254	611	100	80	M24	210	170	28	22
IE1-K22R 355 LY6, 8	FF 740	610	130	700	715	630	140	200	750	254	611	100	80	M24	210	170	28	22

Type designation	GA	GC	H	HA	HD	HD <sup>2)</sup>	HH	K	K'	L	LC	TB Type	AG	LL	AH	BE	O	BI
	t	t1	h	c	p	p	A	s	s'	k	k1	Standard	x	z	-	-	r	BI
IE1-K22R 355 MY2G, M2G	85	-	355	44	1091	1172	250	28	35	1530	-	KK 630 A	496	390	301	140	M72 x 2	60
IE1-K22R 355 MY4, 6, 8	106	85	355	44	1091	1172	250	28	35	1570	1755	KK 630 A	496	390	301	140	M72 x 2	60
IE1-K22R 355 M4	106	85	355	44	1091	1172	250	28	35	1570	1755	KK 630 A	496	390	301	140	M72 x 2	60
IE1-K22R 355 M6, 8	106	85	355	44	1091	1172	250	28	35	1570	1755	KK 630 A	496	390	301	140	M72 x 2	60
IE1-K22R 355 MX6, 8	106	85	355	44	1091	1172	327	28	35	1690	1875	KK 630 A	496	390	301	140	M72 x 2	60
IE1-K22R 355 MX2G	85	-	355	44	1083	1174	327	28	35	1650	-	KK 1000 A	615	474	385	200	M72 x 2	60
IE1-K22R 355 LY2G, L2G	85	-	355	44	1083	1174	327	28	35	1650	-	KK 1000 A	615	474	385	200	M72 x 2	60
IE1-K22R 355 MX4	106	85	355	44	1083	1174	327	28	35	1690	1875	KK 1000 A	615	474	385	200	M72 x 2	60
IE1-K22R 355 LY4, L4	106	85	355	44	1083	1174	327	28	35	1690	1875	KK 1000 A	615	474	385	200	M72 x 2	60
IE1-K22R 355 LY6, 8	106	85	355	44	1083	1174	327	28	35	1690	1875	KK 1000 A	615	474	385	200	M72 x 2	60

<sup>1)</sup> Centre holes to DIN 332-DS  
<sup>2)</sup> Terminal box inclined left/right