

DIMENSION - B3

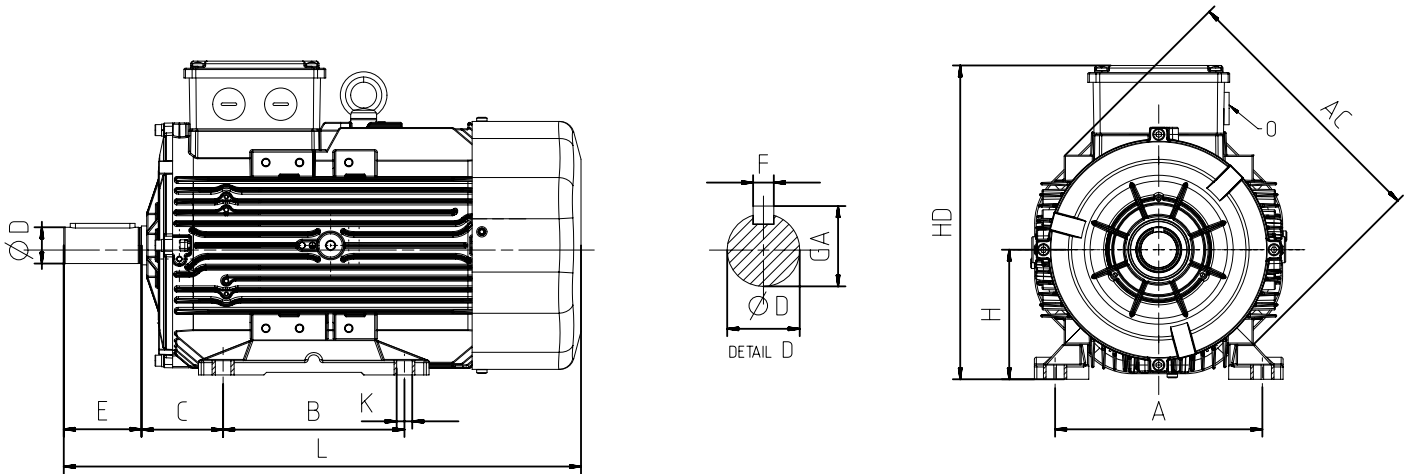

Power [kW]	Number of Poles	Motor Type	Housing Type	Main Dimensions			Foot Mounted Motors				Shaft				Bearing		Seal			
				AC	L	O	B	A	H	HD	K	C	D ⁽¹⁾	E	GA	F ⁽²⁾	Drive Side	Non drive Side	Drive Side	Non drive Side
0.18	8	QIE80M8A	Aluminium	158	284	1*M20	100	125	80	195	10	50	19	40	21.5	6	6204-2Z	6204-2Z	20*30*7	20*30*7
0.25	8	QIE80M8B	Aluminium	158	284	1*M20	100	125	80	195	10	50	19	40	21.5	6	6204-2Z	6204-2Z	20*30*7	20*30*7
0.37	8	QIE90S8A	Aluminium	193	297	1*M25	100	140	90	222	10	56	24	50	27.0	8	6305-2Z	6205-2Z	25*40*7	25*40*7
0.55	8	QIE90L8A	Aluminium	193	317	1*M25	125	140	90	222	10	56	24	50	27.0	8	6305-2Z	6205-2Z	25*40*7	25*40*7
0.75	8	QIE100L8A	Aluminium	217	352	1*M25	140	160	100	241	12	63	28	60	31.0	8	6306-2Z	6205-2Z	30*47*7	25*40*7
1.1	8	QIE100L8B	Aluminium	217	352	1*M25	140	160	100	241	12	63	28	60	31.0	8	6306-2Z	6205-2Z	30*47*7	25*40*7
1.5	8	QIE112M8A	Aluminium	232	396	2*M25	140	190	112	261	12	70	28	60	31.0	8	6306-2Z	6206-2Z	30*47*7	30*47*7
2.2	8	QIE132S8B	Aluminium	279	476	2*M32	140	216	132	314	12	89	38	80	41.0	10	6208-2Z	6208-2Z	40*62*10	40*62*10
3	8	QIE132M8A	Aluminium	279	476	2*M32	178	216	132	314	12	89	38	80	41.0	10	6208-2Z	6208-2Z	40*62*10	40*62*10
4	8	QIE160M8A	Aluminium	302	576	2*M32	210	254	160	360	14.5	108	42	110	45.0	12	6309-2Z	6209-2Z	45*72*10	45*72*10
5.5	8	QIE160M8B	Aluminium	302	576	2*M32	210	254	160	360	14.5	108	42	110	45.0	12	6309-2Z	6209-2Z	45*72*10	45*72*10
7.5	8	QIE160L8A	Aluminium	302	576	2*M32	254	254	160	360	14.5	108	42	110	45.0	12	6309-2Z	6209-2Z	45*72*10	45*72*10
11	8	QIE180L8B	Aluminium	370	629	2*M40	279	279	180	428	14.5	121	48	110	51.5	14	6310-2Z	6310-2Z	50*80*10	50*80*10
15	8	QIE200L8C	Aluminium	415	665	2*M50	305	318	200	461	18.5	133	55	110	59.0	16	6312-2Z	6312-2Z	60*90*10	60*90*10
18.5	8	QIE225S8A	Aluminium	456	765	2*M50	286	356	225	504	18.5	149	60	140	64.0	18	6313-2Z	6313-2Z	65*100*13	65*100*13
22	8	QIE225M8C	Aluminium	456	765	2*M50	311	356	225	504	18.5	149	60	140	64.0	18	6313-2Z	6313-2Z	65*100*13	65*100*13

(1) Tolerance DIN EN 50347 "j6" up to 28mm, "k6" above 28mm

(2) According to DIN 6885

THREE PHASE MOTORS

IE1

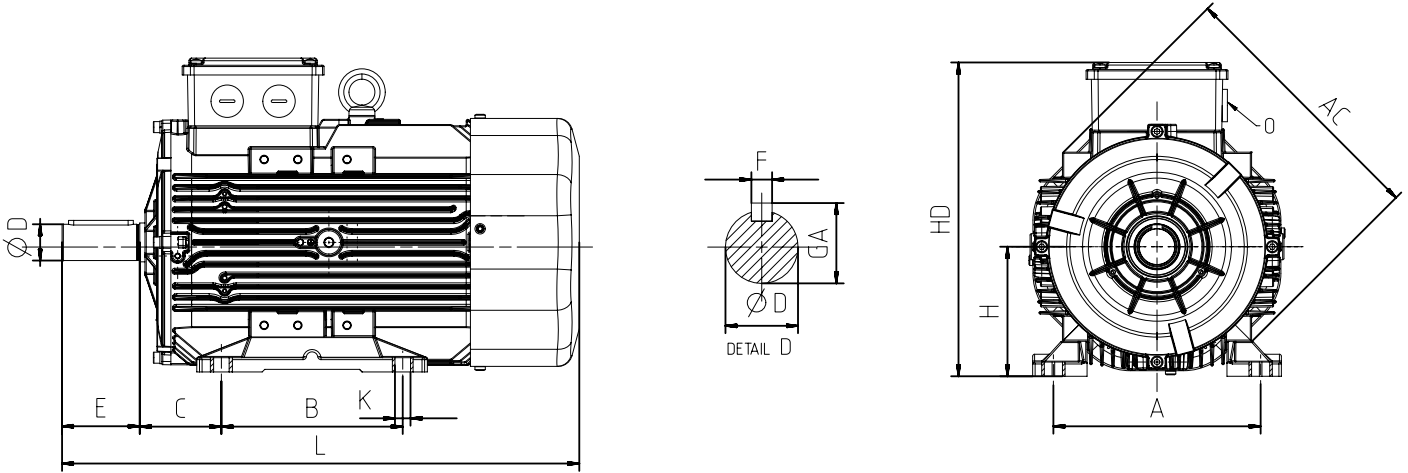

Power [kW]	Number of Poles	Motor Type	Housing Type	Main Dimensions			Foot Mounted Motors						Shaft				Bearing		Seal	
				AC	L	O	B	A	H	HD	K	C	D ⁽¹⁾	E	GA	F ⁽²⁾	Drive Side	Non drive Side	Drive Side	Non drive Side
0.12	4	QIE63M4A	Aluminium	123	219.5	1*M20	80	100	63	174	7	40	11	23	12.5	4	6201-2Z	6201-2Z	12*22*7	12*22*7
0.18	2	QIE63M2A	Aluminium	123	219.5	1*M20	80	100	63	174	7	40	11	23	12.5	4	6201-2Z	6201-2Z	12*22*7	12*22*7
0.18	4	QIE63M4B	Aluminium	123	219.5	1*M20	80	100	63	174	7	40	11	23	12.5	4	6201-2Z	6201-2Z	12*22*7	12*22*7
0.18	6	QIE71M6A	Aluminium	138	252.5	1*M20	90	112	71	190	7	45	14	30	16	5	6202-2Z	6202-2Z	15*24*5	15*24*5
0.18	8	QIE80M8A	Aluminium	158	283.5	1*M20	100	125	80	195	10	50	19	40	21.5	6	6204-2Z	6204-2Z	20*30*7	20*30*7
0.25	2	QIE63M2A	Aluminium	123	219.5	1*M20	80	100	63	174	7	40	11	23	12.5	4	6201-2Z	6201-2Z	12*22*7	12*22*7
0.25	4	QIE63M4B	Aluminium	123	219.5	1*M20	80	100	63	174	7	40	11	23	12.5	4	6201-2Z	6201-2Z	12*22*7	12*22*7
0.25	6	QIE71M6A	Aluminium	138	252.5	1*M20	90	112	71	190	7	45	14	30	16	5	6202-2Z	6202-2Z	15*24*5	15*24*5
0.25	8	QIE80M8A	Aluminium	158	283.5	1*M20	100	125	80	195	10	50	19	40	21.5	6	6204-2Z	6204-2Z	20*30*7	20*30*7
0.37	2	QIE63M2C	Aluminium	123	219.5	1*M20	80	100	63	174	7	40	11	23	12.5	4	6201-2Z	6201-2Z	12*22*7	12*22*7
0.37	2	QIE71M2A	Aluminium	138	252.5	1*M20	90	112	71	190	7	45	14	30	16	5	6202-2Z	6202-2Z	15*24*5	15*24*5
0.37	4	QIE71M4B	Aluminium	138	252.5	1*M20	90	112	71	190	7	45	14	30	16	5	6202-2Z	6202-2Z	15*24*5	15*24*5
0.37	6	QIE80M6A	Aluminium	158	283.5	1*M20	100	125	80	195	10	50	19	40	21.5	6	6204-2Z	6204-2Z	20*30*7	20*30*7
0.37	8	QIE90S8A	Aluminium	193	296.5	1*M25	100	140	90	222	10	56	24	50	27	8	6205-2Z	6205-2Z	25*40*7	25*40*7
0.55	2	QIE71M2B	Aluminium	138	252.5	1*M20	90	112	71	190	7	45	14	30	16	5	6202-2Z	6202-2Z	15*24*5	15*24*5
0.55	4	QIE71M4C	Aluminium	138	252.5	1*M20	90	112	71	190	7	45	14	30	16	5	6202-2Z	6202-2Z	15*24*5	15*24*5
0.55	4	QIE71M4A	Aluminium	158	283.5	1*M20	100	125	80	195	10	50	19	40	21.5	6	6204-2Z	6204-2Z	20*30*7	20*30*7
0.55	6	QIE80M6B	Aluminium	158	283.5	1*M20	100	125	80	195	10	50	19	40	21.5	6	6204-2Z	6204-2Z	20*30*7	20*30*7
0.55	8	QIE90L8A	Aluminium	193	316.5	1*M25	125	140	90	222	10	56	24	50	27	8	6305-2Z	6205-2Z	25*40*7	25*40*7

DIMENSION - B5, B35

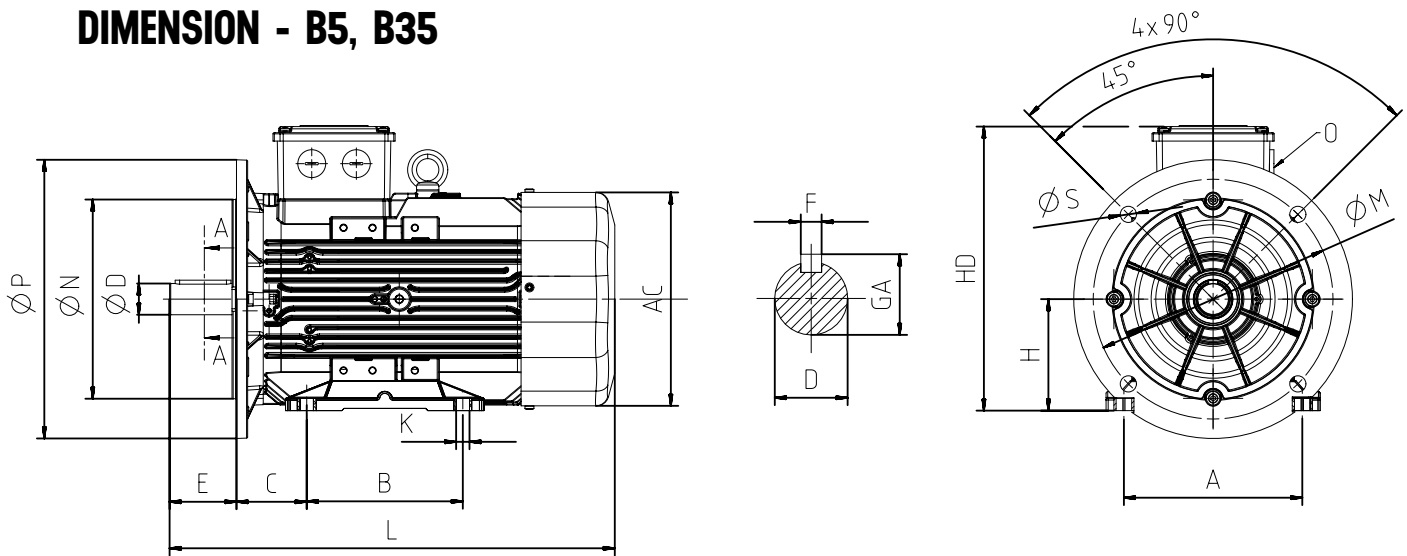

Power [kW]	Number of Poles	Motor Type	Housing Type	Main Dimensions			Foot Mounted Motors				Shaft				Bearing		Seal		Flange [FA] [BS]					
				AC	L	O	B	A	H	HD	K	D ⁽¹⁾	E	GA	F ⁽²⁾	Drive Side	Non drive Side	Drive Side	Non drive Side	P	N ⁽³⁾	M	R	S
0.18	8	QIE80M8A	Aluminium	158	284	1*M20	100	125	80	195	10	19	40	21.5	6	6204-2Z	6204-2Z	20*30*7	20*30*7	200	130	165	0	12
0.25	8	QIE80M8B	Aluminium	158	284	1*M20	100	125	80	195	10	19	40	21.5	6	6204-2Z	6204-2Z	20*30*7	20*30*7	200	130	165	0	12
0.37	8	QIE90S8A	Aluminium	193	297	1*M25	100	140	90	222	10	24	50	27.0	8	6305-2Z	6205-2Z	25*40*7	25*40*7	200	130	165	0	12
0.55	8	QIE90L8A	Aluminium	193	317	1*M25	125	140	90	222	10	24	50	27.0	8	6305-2Z	6205-2Z	25*40*7	25*40*7	200	130	165	0	12
0.75	8	QIE100L8A	Aluminium	217	352	1*M25	140	160	100	241	12	28	60	31.0	8	6306-2Z	6205-2Z	30*47*7	25*40*7	250	180	215	0	14.5
1.1	8	QIE100L8B	Aluminium	217	352	1*M25	140	160	100	241	12	28	60	31.0	8	6306-2Z	6205-2Z	30*47*7	25*40*7	250	180	215	0	14.5
1.5	8	QIE112M8A	Aluminium	232	396	2*M25	140	190	112	261	12	28	60	31.0	8	6306-2Z	6206-2Z	30*47*7	30*47*7	250	180	215	0	14.5
2.2	8	QIE132S8B	Aluminium	279	476	2*M32	140	216	132	314	12	38	80	41.0	10	6208-2Z	6208-2Z	40*62*10	40*62*10	300	230	265	0	14.5
3	8	QIE132M8A	Aluminium	279	476	2*M32	178	216	132	314	12	38	80	41.0	10	6208-2Z	6208-2Z	40*62*10	40*62*10	300	230	265	0	14.5
4	8	QIE160M8A	Aluminium	302	576	2*M32	210	254	160	360	14.5	42	110	45.0	12	6309-2Z	6209-2Z	45*72*10	45*72*10	350	250	300	0	18.5
5.5	8	QIE160M8B	Aluminium	302	576	2*M32	210	254	160	360	14.5	42	110	45.0	12	6309-2Z	6209-2Z	45*72*10	45*72*10	350	250	300	0	18.5
7.5	8	QIE160L8A	Aluminium	302	576	2*M32	254	254	160	360	14.5	42	110	45.0	12	6309-2Z	6209-2Z	45*72*10	45*72*10	350	250	300	0	18.5
11	8	QIE180L8B	Aluminium	370	629	2*M40	279	279	180	428	14.5	48	110	51.5	14	6310-2Z	6310-2Z	50*80*10	50*80*10	350	250	300	0	18.5
15	8	QIE200L8C	Aluminium	415	665	2*M50	305	318	200	461	18.5	55	110	59.0	16	6312-2Z	6312-2Z	60*90*10	60*90*10	400	300	350	0	18.5
18.5	8	QIE225S8A	Aluminium	456	765	2*M50	286	356	225	504	18.5	60	140	64.0	18	6313-2Z	6313-2Z	65*100*13	65*100*13	450	350	400	0	18.5
22	8	QIE225M8C	Aluminium	456	765	2*M50	311	356	225	504	18.5	60	140	64.0	18	6313-2Z	6313-2Z	65*100*13	65*100*13	450	350	400	0	18.5

(1) Tolerance DIN EN 50347 "j6" up to 28mm, "k6" above 28mm

(2) According to DIN 6885

(3) Tolerance DIN EN 50347 "j6"

THREE PHASE MOTORS

IE1

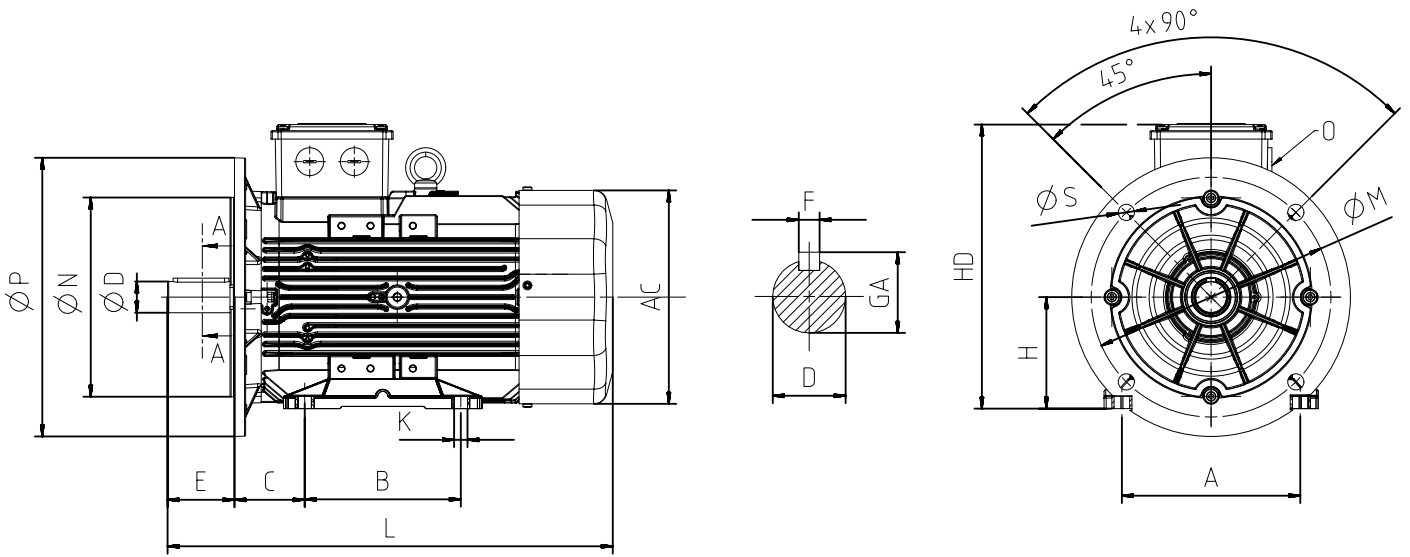

Power [kW]	Number of Poles	Motor Type	Housing Type	Main Dimensions			Foot Mounted Motors					Shaft				Bearing		Seal		Flange [FA] [BS]				
				AC	L	O	B	A	H	HD	K	D ⁽¹⁾	E	GA	F ⁽²⁾	Drive Side	Non drive Side	Drive Side	Non drive Side	P	N ⁽³⁾	M	R	S
0.12	8	QIE63M4A	Aluminium	123	219.5	1*M20	80	100	63	174	7	11	23	12.5	4	6201-2Z	6201-2Z	12*22*7	12*22*7	140	95	115	0	10
0.18	2	QIE63M2A	Aluminium	123	219.5	1*M20	80	100	63	174	7	11	23	12.5	4	6201-2Z	6201-2Z	12*22*7	12*22*7	140	95	115	0	10
0.18	4	QIE63M4B	Aluminium	123	219.5	1*M20	80	100	63	174	7	11	23	12.5	4	6201-2Z	6201-2Z	12*22*7	12*22*7	140	95	115	0	10
0.18	6	QIE71M6A	Aluminium	138	252.5	1*M20	90	112	71	190	7	14	30	16	5	6202-2Z	6202-2Z	15*24*5	15*24*5	160	110	130	0	10
0.18	8	QIE80M8A	Aluminium	158	283.5	1*M20	100	125	80	195	10	19	40	21.5	6	6204-2Z	6204-2Z	20*30*7	20*30*7	200	130	165	0	12
0.25	2	QIE63M2B	Aluminium	123	219.5	1*M20	80	100	63	174	7	11	23	12.5	4	6201-2Z	6201-2Z	12*22*7	12*22*7	140	95	115	0	10
0.25	4	QIE71M4A	Aluminium	138	252.5	1*M20	90	112	71	190	7	14	30	16	5	6202-2Z	6202-2Z	15*24*5	15*24*5	160	110	130	0	10
0.25	6	QIE71M6B	Aluminium	138	252.5	1*M20	90	112	71	190	7	14	30	16	5	6202-2Z	6202-2Z	15*24*5	15*24*5	160	110	130	0	10
0.25	8	QIE80M8B	Aluminium	158	283.5	1*M20	100	125	80	195	10	19	40	21.5	6	6204-2Z	6204-2Z	20*30*7	20*30*7	200	130	165	0	12
0.37	2	QIE63M2C	Aluminium	123	219.5	1*M20	80	100	63	174	7	11	23	12.5	4	6201-2Z	6201-2Z	12*22*7	12*22*7	140	95	115	0	10
0.37	2	QIE71M2A	Aluminium	138	252.5	1*M20	90	112	71	190	7	14	30	16	5	6202-2Z	6202-2Z	15*24*5	15*24*5	160	110	130	0	10
0.37	4	QIE71M4B	Aluminium	138	252.5	1*M20	90	112	71	190	7	14	30	16	5	6202-2Z	6202-2Z	15*24*5	15*24*5	160	110	130	0	10
0.37	6	QIE80M6A	Aluminium	158	283.5	1*M20	100	125	80	195	10	19	40	21.5	6	6204-2Z	6204-2Z	20*30*7	20*30*7	200	130	165	0	12
0.37	8	QIE90S8A	Aluminium	193	296.5	1*M25	100	140	90	222	10	24	50	27	8	6305-2Z	6205-2Z	25*40*7	25*40*7	200	130	165	0	12
0.55	2	QIE71M2B	Aluminium	138	252.5	1*M20	90	112	71	190	7	14	30	16	5	6202-2Z	6202-2Z	15*24*5	15*24*5	160	110	130	0	10
0.55	4	QIE71M4C	Aluminium	138	252.5	1*M20	90	112	71	190	7	14	30	16	5	6202-2Z	6202-2Z	15*24*5	15*24*5	160	110	130	0	10
0.55	4	QIE80M4A	Aluminium	158	283.5	1*M20	100	125	80	195	10	19	40	21.5	6	6204-2Z	6204-2Z	20*30*7	20*30*7	200	130	165	0	12
0.55	6	QIE80M6B	Aluminium	158	283.5	1*M20	100	125	80	195	10	19	40	21.5	6	6204-2Z	6204-2Z	20*30*7	20*30*7	200	130	165	0	12
0.55	8	QIE90L8A	Aluminium	193	316.5	1*M25	125	140	90	222	10	24	50	27	8	6305-2Z	6205-2Z	25*40*7	25*40*7	200	130	165	0	12

DIMENSION - B14a, B34a

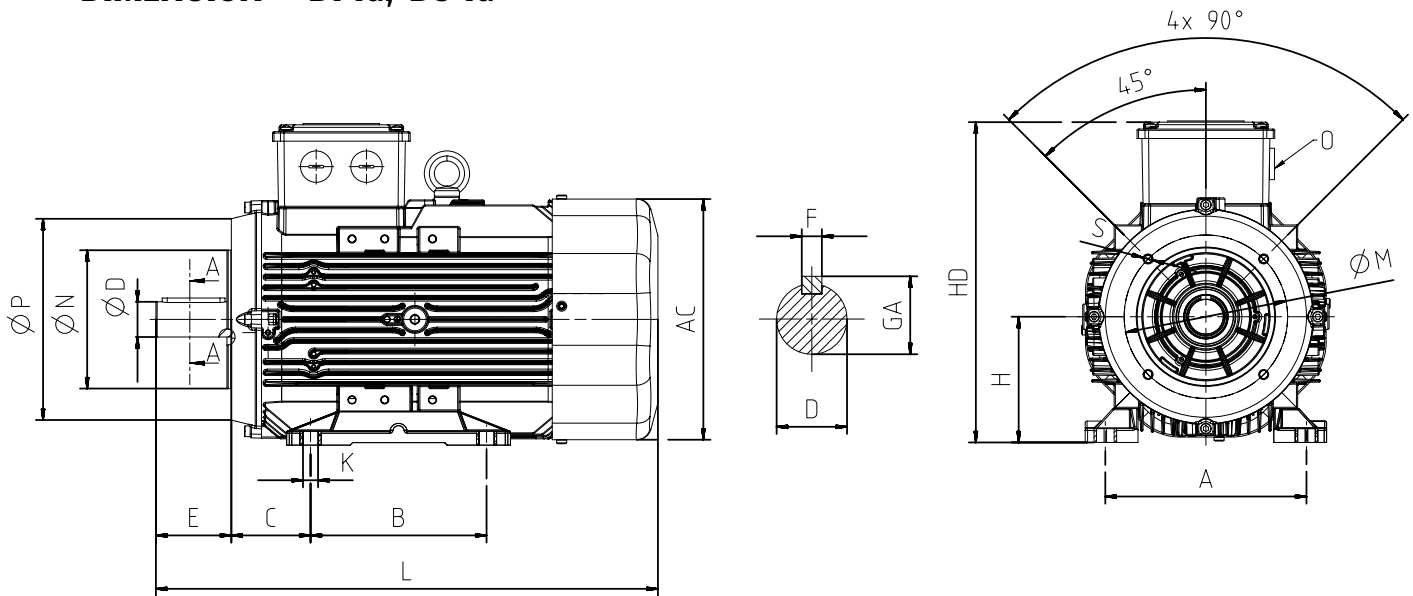

Power [kW]	Number of Poles	Motor Type	Housing Type	Main Dimensions		Foot Mounted Motors					Shaft			Bearing		Seal		Flange [FC] [B14a]						
				AC	L	O	B	A	H	HD	K	D ⁽¹⁾	E	GA	F ⁽²⁾	Drive Side	Non drive Side	Drive Side	Non drive Side	P	N ⁽³⁾	M	R	S
0.18	8	QIE80M8A	Aluminium	158	284	1*M20	100	125	80	195	10	19	40	21.5	6	6204-2Z	6204-2Z	20*30*7	20*30*7	120	80	100	0	M6
0.25	8	QIE80M8B	Aluminium	158	284	1*M20	100	125	80	195	10	19	40	21.5	6	6204-2Z	6204-2Z	20*30*7	20*30*7	120	80	100	0	M6
0.37	8	QIE90S8A	Aluminium	193	297	1*M25	100	140	90	222	10	24	50	27	8	6305-2Z	6205-2Z	25*40*7	25*40*7	140	95	115	0	M8
0.55	8	QIE90L8A	Aluminium	193	317	1*M25	125	140	90	222	10	24	50	27	8	6305-2Z	6205-2Z	25*40*7	25*40*7	140	95	115	0	M8
0.75	8	QIE100L8A	Aluminium	217	352	1*M25	140	160	100	241	12	28	60	31	8	6306-2Z	6205-2Z	30*47*7	25*40*7	160	110	130	0	M8
1.1	8	QIE100L8B	Aluminium	217	352	1*M25	140	160	100	241	12	28	60	31	8	6306-2Z	6205-2Z	30*47*7	25*40*7	160	110	130	0	M8
1.5	8	QIE112M8A	Aluminium	232	396	2*M25	140	190	112	261	12	28	60	31	8	6306-2Z	6206-2Z	30*47*7	30*47*7	160	110	130	0	M8
2.2	8	QIE132S8B	Aluminium	279	476	2*M32	140	216	132	314	12	38	80	41	10	6208-2Z	6208-2Z	40*62*10	40*62*10	200	130	165	0	M10
3	8	QIE132M8A	Aluminium	279	476	2*M32	178	216	132	314	12	38	80	41	10	6208-2Z	6208-2Z	40*62*10	40*62*10	200	130	165	0	M10

(1) Tolerance DIN EN 50347 "j6" up to 28mm, "k6" above 28mm

(2) According to DIN 6885

(3) Tolerance DIN EN 50347 "j6"

THREE PHASE MOTORS

IE1

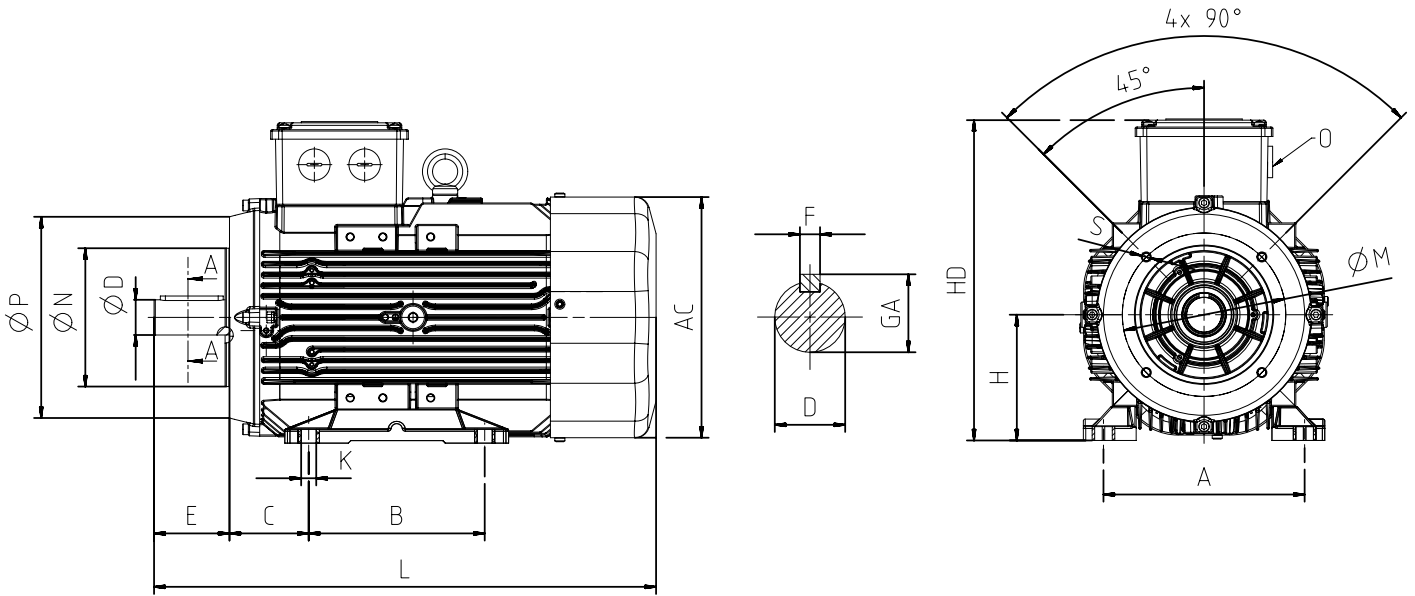

Power [kW]	Number of Poles	Motor Type	Housing Type	Main Dimensions			Foot Mounted Motors					Shaft				Bearing		Seal		Flange [FC] [B14a]				
				AC	L	O	B	A	H	HD	K	D ⁽¹⁾	E	GA	F ⁽²⁾	Drive Side	Non drive Side	Drive Side	Non drive Side	P	N ⁽³⁾	M	R	S
0.12	4	Q1E63M4A	Aluminium	123	219.5	1*M20	80	100	63	174	7	11	23	12.5	4	6201-2Z	6201-2Z	12*22*7	12*22*7	90	60	75	0	M5
0.18	2	Q1E63M2A	Aluminium	123	219.5	1*M20	80	100	63	174	7	11	23	12.5	4	6201-2Z	6201-2Z	12*22*7	12*22*7	90	60	75	0	M5
0.18	4	Q1E63M4B	Aluminium	123	219.5	1*M20	80	100	63	174	7	11	23	12.5	4	6201-2Z	6201-2Z	12*22*7	12*22*7	90	60	75	0	M5
0.18	6	Q1E71M6A	Aluminium	138	252.5	1*M20	90	112	71	190	7	14	30	16	5	6202-2Z	6202-2Z	15*24*5	15*24*5	105	70	85	0	M6
0.18	8	Q1E80M8A	Aluminium	158	283.5	1*M20	100	125	80	195	10	19	40	21.5	6	6204-2Z	6204-2Z	20*30*7	20*30*7	120	80	100	0	M6
0.25	2	Q1E63M2B	Aluminium	123	219.5	1*M20	80	100	63	174	7	11	23	12.5	4	6201-2Z	6201-2Z	12*22*7	12*22*7	90	60	75	0	M5
0.25	4	Q1E71M4A	Aluminium	138	252.5	1*M20	90	112	71	190	7	14	30	16	5	6202-2Z	6202-2Z	15*24*5	15*24*5	105	70	85	0	M6
0.25	6	Q1E71M6B	Aluminium	138	252.5	1*M20	90	112	71	190	7	14	30	16	5	6202-2Z	6202-2Z	15*24*5	15*24*5	105	70	85	0	M6
0.25	8	Q1E80M8B	Aluminium	158	283.5	1*M20	100	125	80	195	10	19	40	21.5	6	6204-2Z	6204-2Z	20*30*7	20*30*7	120	80	100	0	M6
0.37	2	Q1E63M2C	Aluminium	123	219.5	1*M20	80	100	63	174	7	11	23	12.5	4	6201-2Z	6201-2Z	12*22*7	12*22*7	90	60	75	0	M5
0.37	2	Q1E71M2A	Aluminium	138	252.5	1*M20	90	112	71	190	7	14	30	16	5	6202-2Z	6202-2Z	15*24*5	15*24*5	105	70	85	0	M6
0.37	4	Q1E71M4B	Aluminium	138	252.5	1*M20	90	112	71	190	7	14	30	16	5	6202-2Z	6202-2Z	15*24*5	15*24*5	105	70	85	0	M6
0.37	6	Q1E80M6A	Aluminium	158	283.5	1*M20	100	125	80	195	10	19	40	21.5	6	6204-2Z	6204-2Z	20*30*7	20*30*7	120	80	100	0	M6
0.37	8	Q1E90S8A	Aluminium	193	296.5	1*M25	100	140	90	222	10	24	50	27	8	6305-2Z	6205-2Z	25*40*7	25*40*7	140	95	115	0	M8
0.55	2	Q1E71M2B	Aluminium	138	252.5	1*M20	90	112	71	190	7	14	30	16	5	6202-2Z	6202-2Z	15*24*5	15*24*5	105	70	85	0	M6
0.55	4	Q1E71M4C	Aluminium	138	252.5	1*M20	90	112	71	190	7	14	30	16	5	6202-2Z	6202-2Z	15*24*5	15*24*5	105	70	85	0	M6
0.55	4	Q1E80M4A	Aluminium	158	283.5	1*M20	100	125	80	195	10	19	40	21.5	6	6204-2Z	6204-2Z	20*30*7	20*30*7	120	80	100	0	M6
0.55	6	Q1E80M6B	Aluminium	158	283.5	1*M20	100	125	80	195	10	19	40	21.5	6	6204-2Z	6204-2Z	20*30*7	20*30*7	120	80	100	0	M6
0.55	8	Q1E90L8A	Aluminium	193	316.5	1*M25	125	140	90	222	10	24	50	27	8	6305-2Z	6205-2Z	25*40*7	25*40*7	140	95	115	0	M8

DIMENSION - B14b, B34b

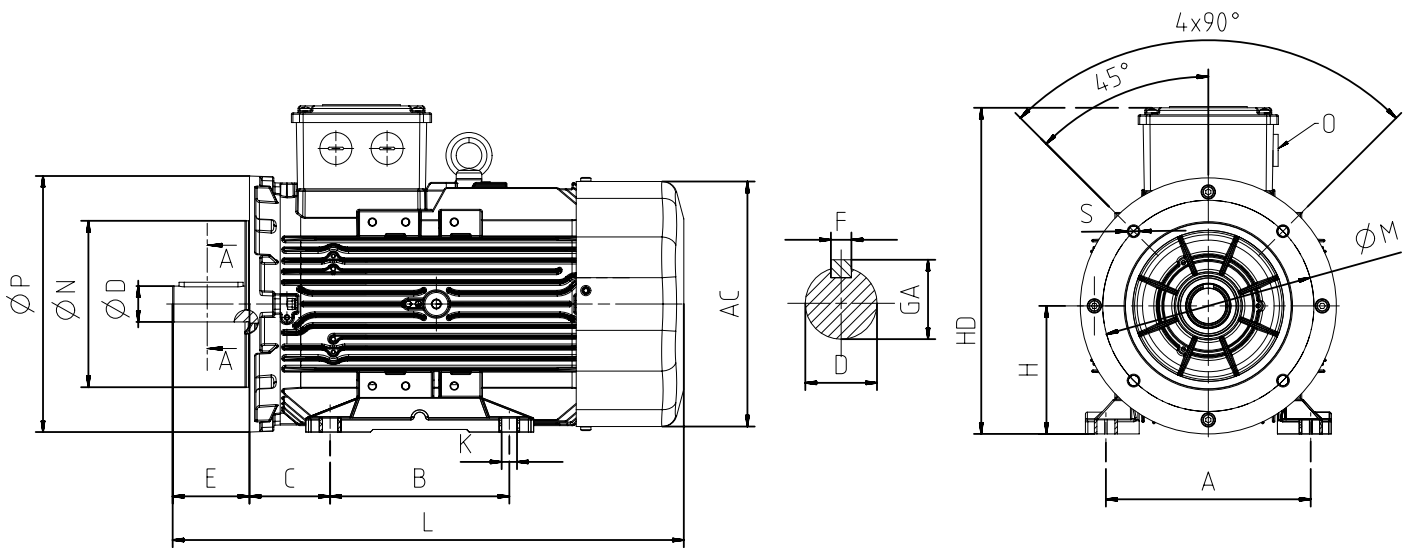

Power [kW]	Number of Poles	Motor Type	Housing Type	Main Dimensions			Foot Mounted Motors					Shaft				Bearing		Seal		Flange [FB] [B14b]				
				AC	L	O	B	A	H	HD	K	D ⁽¹⁾	E	GA	F ⁽²⁾	Drive Side	Non drive Side	Drive Side	Non drive Side	P	N ⁽³⁾	M	R	S
0.18	8	QIE80M8A	Aluminium	158	284	1*M20	100	125	80	195	10	19	40	21.5	6	6204-2Z	6204-2Z	20*30*7	20*30*7	160	110	130	0	M8
0.25	8	QIE80M8B	Aluminium	158	284	1*M20	100	125	80	195	10	19	40	21.5	6	6204-2Z	6204-2Z	20*30*7	20*30*7	160	110	130	0	M8
0.37	8	QIE90S8A	Aluminium	193	297	1*M25	100	140	90	222	10	24	50	27	8	6305-2Z	6205-2Z	25*40*7	25*40*7	160	110	130	0	M8
0.55	8	QIE90L8A	Aluminium	193	317	1*M25	125	140	90	222	10	24	50	27	8	6305-2Z	6205-2Z	25*40*7	25*40*7	160	110	130	0	M8
0.75	8	QIE100L8A	Aluminium	217	352	1*M25	140	160	100	241	12	28	60	31	8	6306-2Z	6205-2Z	30*47*7	25*40*7	200	130	165	0	M10
1.1	8	QIE100L8B	Aluminium	217	352	1*M25	140	160	100	241	12	28	60	31	8	6306-2Z	6205-2Z	30*47*7	25*40*7	200	130	165	0	M10
1.5	8	QIE112M8A	Aluminium	232	396	2*M25	140	190	112	261	12	28	60	31	8	6306-2Z	6206-2Z	30*47*7	30*47*7	200	130	165	0	M10
2.2	8	QIE132S8B	Aluminium	279	441	2*M32	140	216	132	314	12	38	80	41	10	6208-2Z	6208-2Z	40*62*10	40*62*10	160	110	130	0	M12
3	8	QIE132M8A	Aluminium	279	476	2*M32	178	216	132	314	12	38	80	41	10	6208-2Z	6208-2Z	40*62*10	40*62*10	250	180	215	0	M12

(1) Tolerance DIN EN 50347 "j6" up to 28mm, "k6" above 28mm

(2) According to DIN 6885

(3) Tolerance DIN EN 50347 "j6"

THREE PHASE MOTORS

IE1

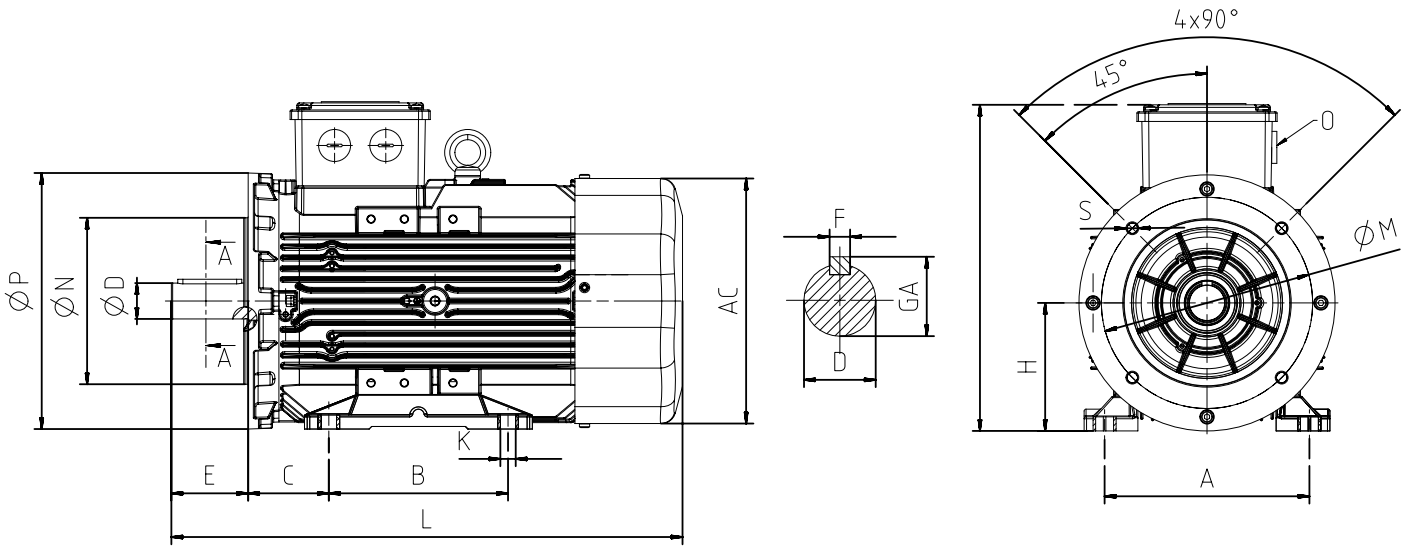

Power [kW]	Number of Poles	Motor Type	Main Dimensions			Foot Mounted Motors					Shaft				Bearing		Seal		Flange [FB] [B14b]				
			AC	L	O	B	A	H	HD	K	D ⁽¹⁾	E	GA	F ⁽²⁾	Drive Side	Non drive Side	Drive Side	Non drive Side	P	N ⁽³⁾	M	R	S
0.12	4	QIE63M4A	123	219.5	1*M20	80	100	63	174	7	11	23	12.5	4	6201-2Z	6201-2Z	12*22*7	12*22*7	120	80	100	0	M6
0.18	2	QIE63M2A	123	219.5	1*M20	80	100	63	174	7	11	23	12.5	4	6201-2Z	6201-2Z	12*22*7	12*22*7	120	80	100	0	M6
0.18	4	QIE63M4B	123	219.5	1*M20	80	100	63	174	7	11	23	12.5	4	6201-2Z	6201-2Z	12*22*7	12*22*7	120	80	100	0	M6
0.18	6	QIE71M6A	138	252.5	1*M20	90	112	71	190	7	14	30	16	5	6202-2Z	6202-2Z	15*24*5	15*24*5	140	95	115	0	M8
0.18	8	QIE80M8A	158	283.5	1*M20	100	125	80	195	10	19	40	21.5	6	6204-2Z	6204-2Z	20*30*7	20*30*7	160	110	130	0	M8
0.25	2	QIE63M2B	123	219.5	1*M20	80	100	63	174	7	11	23	12.5	4	6201-2Z	6201-2Z	12*22*7	12*22*7	120	80	100	0	M6
0.25	4	QIE71M4A	138	252.5	1*M20	90	112	71	190	7	14	30	16	5	6202-2Z	6202-2Z	15*24*5	15*24*5	140	95	115	0	M8
0.25	6	QIE71M6B	138	252.5	1*M20	90	112	71	190	7	14	30	16	5	6202-2Z	6202-2Z	15*24*5	15*24*5	140	95	115	0	M8
0.25	8	QIE80M8B	158	283.5	1*M20	100	125	80	195	10	19	40	21.5	6	6204-2Z	6204-2Z	20*30*7	20*30*7	160	100	130	0	M8
0.37	2	QIE63M2C	123	219.5	1*M20	80	100	63	174	7	11	23	12.5	4	6201-2Z	6201-2Z	12*22*7	12*22*7	120	80	130	0	M6
0.37	2	QIE71M2A	138	252.5	1*M20	90	112	71	190	7	14	30	16	5	6202-2Z	6202-2Z	15*24*5	15*24*5	140	95	115	0	M8
0.37	4	QIE71M4B	138	252.5	1*M20	90	112	71	190	7	14	30	16	5	6202-2Z	6202-2Z	15*24*5	15*24*5	140	95	115	0	M8
0.37	6	QIE80M6A	158	283.5	1*M20	100	125	80	195	10	19	40	21.5	6	6204-2Z	6204-2Z	20*30*7	20*30*7	160	110	130	0	M8
0.37	8	QIE90S8A	193	296.5	1*M25	100	140	90	222	10	24	50	27	8	6305-2Z	6205-2Z	25*40*7	25*40*7	180	110	130	0	M8
0.55	2	QIE71M2B	138	252.5	1*M20	90	112	71	190	7	14	30	16	5	6202-2Z	6202-2Z	15*24*5	15*24*5	140	95	115	0	M8
0.55	4	QIE71M4C	138	252.5	1*M20	90	112	71	190	7	14	30	16	5	6202-2Z	6202-2Z	15*24*5	15*24*5	140	95	115	0	M8
0.55	4	QIE80M4A	158	283.5	1*M20	100	125	80	195	10	19	40	21.5	6	6204-2Z	6204-2Z	20*30*7	20*30*7	160	110	130	0	M8
0.55	6	QIE80M6B	158	283.5	1*M20	100	125	80	195	10	19	40	21.5	6	6204-2Z	6204-2Z	20*30*7	20*30*7	160	110	130	0	M8
0.55	8	QIE90L8A	193	316.5	1*M25	125	140	90	222	10	24	50	27	8	6305-2Z	6205-2Z	25*40*7	25*40*7	160	110	130	0	M8